

CLEVELAND WHEELS & BRAKES

CLEVELAND WHEELS & BRAKES FOR HOMEBUILTS



Wheels with matching hydraulic disc brakes are made from magnesium alloy castings to give a lightweight, durable unit. Wheels complete with bearings and wheel covers. Brake assembly has linings installed. Sold in pairs only.

500 x 5, Wt. 5.75 Lbs. Each (Wheel P/N 40-78B, Brake P/N 30-9)
 Kit P/N 199-102 (Std. Disc)\$627.00 /Pr
 Kit P/N 199-102C (Chrome Disc)\$858.00 /Pr
 Use Lining P/N 66-106. Fits 1-1/4" dia. axles.

600 x 6, Wt. 7-3/4 Lbs. Each (Wheel P/N 40-59A, Brake P/N 30-59A)
 Kit P/N 199-104 (Std. Disc)\$896.00 /Pr
 Kit P/N 199-104C (Chrome Disc)\$1,052.00 /Pr
 Use Lining P/N 66-105. Fits 1-1/2" dia. axles.

600 x 6, with Master Cylinders for Defiant
 Special set consists of (2) P/N 40-75B wheels, (2) P/N 30-52 brake assemblies and (2) P/N 10-34 master cylinders.
 P/N 199-133X\$1,321.00

500 x 5 NOSE WHEEL - Magnesium, with bearings.
 For 1-1/4" dia. axle.P/N 40-77C\$282.95

600 x 6 NOSE WHEEL - Anodized aluminum, with bearings.
 For 1-1/2" dia. axle.P/N 40-56\$612.00

HEAVY-DUTY CLEVELAND WHEELS & BRAKES FOR HOMEBUILTS



The heavier-duty brake discs, linings and hardware in these kits will increase braking capacity for the heavier, faster-landing aircraft now being designed & built.

#199-93 UPGRADE KIT - For #199-102 standard wheels and brakes. Upgrades current 40-78B/ 30-9 to new 40-230/30-181 specs. Consists of #66-106 linings, discs, shims, bolts, rivets and nameplates for 2 wheels & brakes.
 P/N 199-93\$308.95

#199-156 KIT FOR VARIEZE (AIRCRAFT TO 1500 LBS) - Kit consists of two 40-230 wheel assemblies and two 30-181 brake assemblies. Uses #66-106 linings. Fits 1-1/4" dia. axles.
 P/N 199-156\$728.00

#199-152 KIT FOR LONG-EZ & COZY (AIRCRAFT TO 2200 LBS) - Kit contains two 40-151 wheel assemblies and two 30-133 brake assemblies. Uses #66-55 linings. Fits 1-1/4" dia. axles.
 P/N 199-152\$827.00

CLEVELAND WHEELS & BRAKES FOR AMPHIBIANS



Although magnesium wheels and brakes are considerably lighter, magnesium is subject to corrosion and should not be used for amphibious operation. Only organic linings should be used on all brakes. All parts of the 500 x 5 size wheels and brakes for amphibians are constructed of anodized aluminum for water resistance. Although a special 40-74 series of 600 x 6 wheels and brakes are manufactured for amphibious use, with chrome plated bearings and brake disc and water drainage holes, they are too costly for use on homebuilt aircraft.

The use of standard Cleveland aluminum wheels with standard bearings on amphibian aircraft is suggested. If bearings are kept well greased, reasonable service can be expected, but earlier bearing replacement should be anticipated.

500 x 5 (Anodized Aluminum)
 Kit P/N 199-103 (Std. Disc)\$1,117.00 Pr
 Kit P/N 199-103C (Chrome Disc)\$1,097.00 Pr

600 x 6 (Anodized Aluminum)
 Kit P/N 199-105 (Std. Disc)\$888.00 Pr
 Kit P/N 199-105C (Chrome Disc)\$963.00 Pr

500 x 5 Aluminum Nose Wheel, P/N 40-87C\$388.70

AEROSHELL GREASE FOR WHEEL BEARINGS

Aeroshell #22 grease is recommended for lubrication of Cleveland wheel bearings and is also applicable to other similar wheel bearings. Meets Mil-G-81322. 14 oz. tubeP/N 08-05490\$14.65

CLEVELAND HOMEBUILDERS SPECIAL WHEEL & BRAKE SET PACKAGES



PACKAGE NO. 1 - Includes 2 Cleveland 5.00-5 magnesium wheels & brakes plus (2) 6 ply tires & tubes. (Wt. approx. 28 lbs.)

A w/McCreary Air Trac Tires & Tubes P/N 06-00100\$796.30

B w/Goodyear Flight Custom II Tires (Goodyear's latest design) P/N 06-00200\$989.40

C w/Lamb Tires & Tubes (11.400 x 5) P/N 06-00300\$686.80

PACKAGE NO. 2 - Package No. 1 plus 2 Cleveland #10-35 master cylinders. (Wt. approx. 30 lbs.)

A w/McCreary Air Trac Tires & TubesP/N 06-00400\$1,278.20

B w/G.Year Flight CustomII Tires & Tubes ..P/N 06-00500.....\$1,471.30

C w/Lamb Tires & Tubes (11.400x5)P/N 06-00600.....\$1,099.00

PACKAGE NO. 3 - Includes 2 Cleveland 6.00-6 magnesium wheels and brakes plus two 4 ply tires and tubes. (Wt. approx. 32 lbs.)

A w/McCreary Air Trac Tires & TubesP/N 06-00700\$999.00

B w/G.Year Flight CustomII Tires & Tubes ..P/N 06-00800.....\$1,226.00

PACKAGE NO. 4 - Package No. 3 plus 2 Cleveland #10-35 master cylinders. (Wt. approx. 34 lbs.)

A w/McCreary Air Trac Tires & TubesP/N 06-00900.....\$1,456.00

B w/G.Year Flight Custom II Tires & Tubes ..P/N 06-01000.....\$1,683.00

PACKAGE NO. 5 - Includes 2 Cleveland 6.00-6 magnesium wheels & brakes plus two low-profile lightweight 6-ply 15x6.00-6 tires & tubes. (Wt. approx. 32 lbs.)

A w/McCreary Air Trac Tires & TubesP/N 06-01100\$1,047.00

B w/G.Year Flight Custom II Tires & Tubes ..P/N 06-01200.....\$1,178.00

PACKAGE NO. 6 - Package No. 5 plus 2 Cleveland #10-35 master cylinders. (Wt. approx. 34 lbs.)

A w/McCreary Air Trac Tires & TubesP/N 06-01300.....\$1,504.00

B w/G.Year Flight Custom II Tires & Tubes ..P/N 06-01400.....\$1,635.00

PACKAGE NO. 7 FOR DEFIANT - Includes 2 Cleveland 6.00-6 magnesium wheels & brakes (P/N 199-133X) plus (2) 6.00-6 McCreary 6 ply tires & tubes plus 2 master cylinders.P/N 06-01500\$1,386.00

LG

HEGAR WHEEL KITS



Spun aluminum wheel kit includes aluminum wheel halves, hubs, 5/8 bearings, valve, tubeless kit and all necessary hardware. Compatible with Hegar brakes.

Note: Order tires separately.

4X6 Offset rimP/N WH005.1

4X6 Symmetrical (Quicksilver®)P/N WH005.1Q

5X6 Offset rimP/N WH022.1

5X6 Symmetrical (Quicksilver®)P/N WH022.1Q

6X6 Offset rimP/N WH002.1

6X6 Symmetrical (Quicksilver®)P/N WH002.1Q

Price Each\$84.25

The following Hegar wheels are designed to fit Quicksilver® nose gear allowing clearance for the steering fork.

3.5X5 MX(L) Nose WheelP/N WH023.1\$111.95

3.5X6 MX(L) Nose WheelP/N WH024.1\$97.25

HEGAR EXTERNAL DISC BRAKES

Heavy duty hydraulic external disk brakes for use with all Hegar wheels. Black anodized billet aluminum, 1/8" thick steel disk. Set includes 15 feet of high pressure nylon brake line, fluid with bleeder kit, and fittings. Axles and master cylinders must be ordered separately. Specify 5/8" or 3/4" bearings. P/N 06-00326\$442.95

HEGAR BRAKE ACCESSORIES

BRAKE ACCESSORIES - Order the type of master cylinder(s) & actuator best suited to your aircraft. Standard keyed axles for all aircraft, except Quicksilver®.

Heel-Operated Master CylinderP/N WBK01.1\$54.25

Joystick-Mounted Master CylinderP/N WBK01.2\$86.75

Foot LinkageP/N WBK01.3\$90.25

Hand LinkageP/N WBK01.4\$90.25

Axles, 5/8" Standard, set of 2P/N WBK01.5\$36.85

Axles, 5/8" Quicksilver® Type, set of 2P/N WBK01.6\$63.25

Axles, 3/4" Standard, set of 2P/N WBK01.7\$36.10

MATCO WHEELS & BRAKES

NOTE: Our prices include 2 wheels and 2 brakes (set)

W51LT/LXT



The W51LT/LXT is a 5" wheel with a 4.775" width with an additional 1.23 inch caliper spacing. Bearing spacing is 3.084" and axle spacing is 1.00". The total weight of this wheel and brake assembly is 9.2 Lbs. The bearing axle diameter is 1.25". Torque rating is 4266 in-lb for the W51LT and is 6143 in-lb for the W51LXT. W51LT is recommended for Cozy Mark IV and the W51LXT is used on the Glasair.

W51LT	06-00079	\$527.00
W51LT w/axles	06-00568	\$669.00
W51LXT	06-00412	\$589.00
W51LXT w/axles.....	06-00569	\$731.00

MMHE6B



MHE6B-SC MHE6B

The MHE6B E SERIES is a 6" wheel with 5.375" width with an additional 1.39 inch caliper spacing. Bearing spacing is 2.71" and axle spacing is 0.68". The total weight of this wheel and brake assembly is 5.8 lbs. The bearing axle diameter is 1.25". Use on various light support aircraft. Torque Rating (@450 PSI): 2085 in-lb. Order axles separately.

MHE6B	P/N 06-00444	\$515.95
MHE6BSC	P/N 06-00443	\$515.95

AP

WE51



The WE51 is a 5" wheel with 4.3" width with an additional 1.39" caliper spacing. Bearing spacing is 3.27" and axle spacing is 0.945". The total weight of this wheel and brake assembly is 7.5 lbs. The bearing axle diameter is 1.25". Torque Rating (@450 PSI): 2085 inlb. Any 500X5 tire and tube combination can be used with this tire.

WE51	P/N 06-00445	\$485.95
WE51 w/axles	P/N 06-00570	\$591.95

W600XT



The W600XT is a 6" wheel with 6.3125" width with an additional 1.37" caliper spacing. Bearing spacing is 3.42" and axle spacing is 1.78". The total weight of this wheel and brake assembly is 11.9 lbs. The bearing axle diameter is 1.50". Torque Rating (@450 PSI): 6441 inlb. Static Capacity: 1860 lbs. Load Limit: 5580 lbs. Order axles separately.

W600XT	P/N 06-00413	\$646.00
--------------	--------------------	-----------------

W51L



MATCO mfg produces a superior 5" wheel and brake assembly for use with aircraft requiring less than 1420 lbs per wheel. This model uses 1.25" TAPER/ROLL bearings. The W51L is a 5" wheel with 4.6" width with an additional 1.23" caliper spacing. Bearing spacing is 3.084" and axle spacing is 1.285". The total weight of this wheel and brake assembly is 6.6 lbs. The bearing axle diameter is 1.25".

W51L	P/N 06-01710	\$433.95
------------	--------------------	-----------------

MH6B



The MH6B is a 6" wheel with 5.375" width with an additional 1.24" caliper spacing. Bearing spacing is 2" and axle spacing is 2". The total weight of this wheel and brake assembly is 4.4 lbs. The bearing axle diameter is 0.625". The NEW MH6B is now produced as a CNC spun wheel with a Tenzalloy hub center and a NEW higher torque caliper. Torque Rating (@450 PSI):1540 in-lb. StaticCapacity:660 lbs.

MH6B	P/N 06-16810	\$446.00
MH6B-S	P/N 06-00447	\$446.00

W50CC



The W50CC is a 5" wheel with a 3.7" width with an additional 1.75" caliper spacing. Bearing Spacing is 3.0" and axle spacing is 2.5". The total weight of this wheel and brake assembly is 4.5 lbs. excluding the axle assembly. This wheel uses a "Lamb" type tire which is 11x400x5 and requires a tube with a 90 degree valve stem. Torque Rating (@450 PSI): 1540 in-lb.

W50CC	P/N 06-00470	\$446.00
-------------	--------------------	-----------------

W60



MATCO mfg produces a superior 6" wheel and brake assembly for use with aircraft requiring less than 1420 lbs per wheel. This model uses 1.25" TAPER/ROLL bearings. The W60 is a 6" wheel with 4.375" width with an additional 1.23" caliper spacing. Bearing spacing is 2.5" and axle spacing is 1.25". The total weight of this wheel and brake assembly is 7.1 lbs. The bearing axle diameter is 1.25".

W60	P/N 06-02160	\$447.95
-----------	--------------------	-----------------

MATCO WHEELS & BRAKES

NOTE: Our prices include 2 wheels and 2 brakes (set)

Matco Part No	Aircraft Spruce	Bearing Axle Dia. BB=Ball TRB=Taper Roll	Load Limit (lbs.)	Static Capacity (lbs.)	Brake Reline Kit	Weight (lbs.)	Tire Size	Tire Type	Price
CNC SPUN WHEELS: INTERNAL CALIPER									
MH6B	06-16810	0.625BB	2000	660	BRL-2	4.4	6"	any 6"	\$446.00
MH6B-S	06-00447	0.625BB	2000	660	BRL-2	4.4	6"	any 6"	\$446.00
MH6B.62D	06-00448	0.625BB	2000	660	BRL-3	4.65	6"	any 6"	\$512.00
MH6B.62D-S	06-00449	0.625BB	2000	660	BRL-3	4.65	6"	any 6"	\$512.00
MH6B.75	06-00450	0.75BB	2000	660	BRL-2	4.4	6"	any 6"	\$446.00
MH6B.75-S	06-00453	0.75BB	2000	660	BRL-2	4.4	6"	any 6"	\$446.00
MH6B.75D	06-00451	0.75BB	2000	660	BRL-3	4.65	6"	any 6"	\$512.00
MH6B.75D-S	06-00452	0.75BB	2000	660	BRL-3	4.65	6"	any 6"	\$512.00
MH6BD.62	06-00454	0.625BB	2000	660	2BRL-2	5.18	6"	any 6"	\$565.00
MH6BD.62-S	06-00455	0.625BB	2000	660	2BRL-2	5.18	6"	any 6"	\$565.00
MH6BD.75	06-00456	0.75BB	2000	660	2BRL-2	5.18	6"	any 6"	\$565.00
MH6BD.75-S	06-00457	0.75BB	2000	660	2BRL-2	5.18	6"	any 6"	\$565.00
CNC SPUN WHEELS: EXTERNAL CALIPER									
MHE6B1.25	06-00444	1.25TRB	2700	900	BRL-1	5.8	6"	up to 6.00-6	\$515.95
MHE6B1.25-C	06-00443	1.25TRB	2700	900	BRL-1	5.8	6"	up to 6.00-6	\$515.95
CENTRIFUGALLY CAST WHEELS: INTERNAL CALIPER									
W40B	06-00458	0.625BB	2000	660	BRL-2	4.05	4"	any 4"	\$458.00
W40-BD	06-00459	0.75BB	3560	1185	BRL-2	3.8	4"	2.80/2.50x4	\$465.00
W40R	06-02210	0.75BB	3560	1185	BRL-2	4.05	4"	any 4"	\$479.95
W50L	06-01860	0.625BB	2000	660	BRL-1	6.6	5"	11.0x4.05	\$433.95
W50L.75	06-00460	0.75BB	2000	660	BRL-1	6.6	5"	11.0x4.05	\$455.00
W50LD	06-00411	1.25BB	4260	1420	2BRL-1	8.9	5"	11.0x4.05	\$517.00
W50LT	06-00461	1.25BB	4260	1420	BRL-6	9.2	5"	11.0x4.05	\$564.00
W50LXT	06-00462	1.25BB	1420	4260	BRL-6	9.2	5"	11.0x4.05	\$673.00
W50S1.25	06-01660	1.25BB	4260	1420	BRL-1	6.6	5"	11.0x4.05	\$433.95
W50S.75	06-00463	0.75BB	4260	1185	BRL-1	6.6	5"	11.0x4.05	\$452.00
W51L	06-01710	1.25BB	4260	1420	BRL-1	6.6	5"	5.00x5	\$433.95
W51LD	06-00464	1.25BB	4260	1420	2BRL-1	8.9	5"	5.00x5	\$549.00
W51LT	06-00079	1.25BB	4260	1420	BRL-6	9.2	5"	5.00x5	\$527.00
W51LXT	06-00412	1.25BB	4260	1420	BRL-6	9.2	5"	5.00x5	\$589.00
W51S1.25	06-01960	1.25BB	4260	1420	BRL-1	6.6	5"	5.00x5	\$433.95
W62	06-02110	0.75BB	3560	1185	BRL-1	7	6"	any 6"	\$443.95
F602	06-00465	0.75BB	3560	1185	BRL-1	7.8	6"	any 6"	\$502.00
W60	06-00460	1.25BB	4260	1420	BRL-1	7.1	6"	any 6"	\$455.00
F600	06-00466	1.25BB	4260	1420	BRL-1	7.8	6"	any 6"	\$502.00
W600	06-00467	1.5TRB	5580	1860	BRL-6	11.9	6"	any 6"	\$627.00
W600XT	06-00413	1.5TRB	5580	1860	BRL-6	11.9	6"	any 6"	\$646.00
W600XLT	06-00468	1.5TRB	5580	1860	BRL-6	10.2	6"	any 6"	\$670.00
W323A	06-00469	1.5TRB	5580	1860	BRL-323	13.75	6"	any 6"	\$1,386.00
CENTRIFUGALLY CAST WHEELS: EXTERNAL CALIPER									
WE51	06-00445	1.25TRB	4260	1420	BRL-1	7.5	6"	5.00x5	\$485.95

AP

MATCO WHEELS & BRAKES

MATCO DIECAST WHEELS

NOTE: Our prices include 2 wheels and 2 brakes (set); Bearing Axle: BB=Ball TRB=Taper Roll

Matco P/N	Our P/N	Bearing Axle Dia.	Load Limit (lbs.)	Static Cap.(lbs.)	Brake Reline Kit	Weight (lbs.)	Tire Size	Tire Type	Price
W50CC	06-00470	0.625BB	2000	660	BRL-2	4.57	5"	11.0 x 4.05	\$446.00
W50CC.62D	06-00471	0.625BB	2000	660	BRL-3	4.82	5"	11.0 x 4.05	\$512.00
W50CC.75	06-00472	0.75BB	2000	660	BRL-2	4.57	5"	11.0 x 4.05	\$446.00
W50CC.75D	06-00473	0.75BB	2000	660	BRL-3	4.82	5"	11.0 x 4.05	\$512.00
W50CCD.75	06-00474	0.75BB	2000	660	2 BRL-2	5.35	5"	11.0 x 4.05	\$565.00
W50DCC.62	06-00475	0.625BB	2000	660	2 BRL-2	5.35	5"	11.0 x 4.05	\$565.00
W51CC	06-00476	0.625BB	2000	660	BRL-2	4.57	5"	5.00-5	\$446.00
W51CC.62D	06-00477	0.625BB	2000	660	2 BRL-3	4.82	5"	5.00-5	\$512.00
W51CC.75	06-00478	0.75BB	2000	660	2 BRL-2	4.57	5"	5.00-5	\$512.00
W51CC.75D	06-00479	0.75BB	2000	660	2 BRL-3	4.82	5"	5.00-5	\$512.00
W51CCD.75	06-00480	0.75BB	2000	660	2 BRL-2	5.35	5"	5.00-5	\$565.00
W51DCC.62	06-00481	0.625BB	2000	660	2 BRL-2	5.35	5"	5.00-5	\$565.00
W60CC	06-00482	0.625BB	2000	660	BRL-2	5.55	6"	up to 6.00-6	\$446.00
W60CC.75	06-00483	0.75BB	2000	660	BRL-2	5.55	6"	up to 6.00-6	\$446.00
W600CC	06-00484	0.625BB	2000	660	BRL-2	5.85	6"	any 6 "	\$465.00
W600CC.75	06-00485	0.75BB	2000	660	BRL-2	5.85	6"	any 6 "	\$465.00
W60CCD.62	06-00486	0.625BB	2000	660	2 BRL-2	5.55	6"	up to 6.00-6	\$565.00
W60CCD.75	06-00487	0.75BB	2000	660	2 BRL-2	5.55	6"	up to 6.00-6	\$565.00
W600CCD.62	06-00488	0.625BB	2000	660	2 BRL-2	5.85	6"	any 6 "	\$565.00
W600CCD.75	06-00489	0.75BB	2000	660	2 BRL-2	5.85	6"	any 6 "	\$565.00
W60CC.75R	06-00490	0.75TRB	2000	1185	BRL-2	5.85	6"	up to 6.00-6	\$465.00
W600CC.75R	06-00491	0.75TRB	2000	1185	BRL-2	6.15	6"	any 6 "	\$537.00
W60CCD.75R	06-00492	0.75TRB	2000	1185	2 BRL-2	6.25	6"	up to 6.00-6	\$565.00
W600CCD.75R	06-00493	0.75TRB	2000	1185	2 BRL-2	6.55	6"	any 6 "	\$592.00
W80CC-Z	06-00494	0.625BB	2000	660	BRL-1	8.75	6"	4.80-8	\$461.00

AP

MATCO AXLE CHART

Matco P/N	Aircraft Spruce P/N	Dia. (In.)	Used on Models	Axle Assy	Comment	Axle Price	Assy Price
A1	06-00495	1.25	W50, W51	AXLE1	AL Flange Mount	\$54.00	\$71.00
A1A	06-00496	1.25	W50LD,W51LD,W50LT, W50LXT,W51LT,W51LXT	AXLE1A	AL Flange Mount	\$54.00	\$71.00
A1B	06-00497	1.25	WE51	AXLE1B	AL Flange Mount	\$53.00	\$71.00
A2	06-00498	1.25	W50S,W51S	AXLE2	AL Flange Mount	\$54.00	\$71.00
A3	06-00499	1.25	W60	AXLE3	AL Flange Mount	\$54.00	\$70.00
A3A	06-00501	1.25	MHE6B	AXLE3A	AL Flange Mount 5"	\$59.00	\$70.00
A3C	06-00502	1.25	MHE6B	AXLE3C	AL Flange Mount 6" Cessna bolt pattern	\$59.00	\$70.00
A4	06-16830	0.625	MHE6B,W50CC,W60CC,W40B	AXLE4	Steel Tube	\$40.00	\$44.00
A5	06-00503	0.75	W40BD	AXLE5	AL Flange Mount	\$60.00	\$63.00
A5G	06-00504	20mm	W40M	AXLE5G	Steel Flange Mount	\$63.00	\$68.00
A6	06-00505	1.5	W600,W600XT,WW600XLT	AXLE6	AL Flange Mount	\$73.00	\$89.00
A6M	06-00506	1.5	W600,W600XT,WW600XLT	AXLE6M	A6 Alternate Mount Ver.	\$73.00	\$89.00
A7	06-00507	0.75	MH6B,W50CC,W60CC,W40B	AXLE7	Steel Tube Mount	\$48.00	\$60.00
A8	06-00508	0.75	W62,MH6B.75,W50CC.7 MH6B5,260CC.75	AXLE8	Steel Tube	\$50.00	\$54.00
A13	06-00509	0.625	W80CC-Z	AXLE13	Steel Tube for Fork Mount	\$49.00	\$55.00
A15	06-00510	1.5	W323A	AXLE15	For W323A Compound W&B	\$73.00	\$91.00
A15M	06-00511	1.5	W323SA	AXLE15M	For W3238A Compound W&B	\$98.00	\$119.00
A16	06-00512	0.75	F602	AXLE16	Steel Tube for W62 w/F602 Spacer	\$50.00	\$54.00
A17	06-00513	0.75	W600CC.75	AXLE17	Steel Tube	\$50.00	\$54.00
A19	06-00514	0.75	W600CC.75R	AXLE19	Steel Tube	\$50.00	\$54.00
A20	06-00515	0.75	NW50.75R,NW51.75R	AXLE20	Steel Tube w/Spacers for Zenith 601	\$46.00	\$52.00

WHEELS & BRAKES

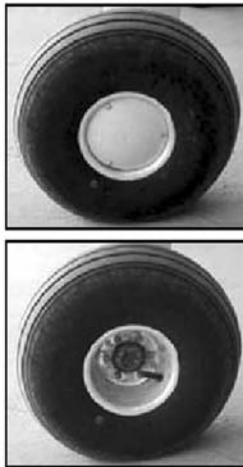

MATCO HUB CAP KIT For MH Series Wheels

Responding to customer inquiries for a kit to allow installation of the current WHLWC wheel cover on MH series wheels, MATCO mfg has introduced the MHWC hub cap kit. The kit includes wheel covers and mounting hardware for 2 wheels. The WHLWC wheel covers are made from durable ABS polymer. The wheel covers can be painted to match customer requirements. Installation can be accomplished without removing the wheel. Installation on MH wheels using the CNC spun wheel halves (introduced in early 2001) can be accomplished in about 10 minutes. On earlier MH series wheels using stamped wheel halves, some trimming of the wheel cover may be required and installation may require about 30 minutes. Furnished unpainted. 2 wheel kit.

P/N 06-00446.....\$15.25

MATCO BRAKE RELINE KITS

Reline kits include linings and rivets for 2 calipers.

Matco Part No.	Our Part No.	Lining Model Used	Price each
BRL-1	06-00571	4 of M66-106	\$27.00
BRL-1	06-00572	4 of M66-103	\$27.00
BRL-1	06-00573	4 of M66-1052	\$32.00
BRL-1	06-00574	4 of M66-1052	\$56.00
BRL-1	06-00575	4 of DR323	\$152.00



MATCO 6" WHEELS & BRAKES FOR ULTRALIGHTS

This top quality wheel and brake set is excellent for use on high-performance ultralights. Set incl.: 2 aluminum wheels & brakes with 5/8" bearings, 2 axles, 2 spacers, 2 brake bleeder seats & valves, 4 brake line fittings, 12 ft. of 1/4" dia. x .035 wall brake line & 1 vertical master cylinder. P/N 06-16800\$563.00
Same as set #06-16800 except with 2 vertical master cylinders P/N 06-16840\$663.00
Same as set #06-16800 except with 1 laydown style master cylinder P/N 06-16850\$580.00
Same as set #06-16800 except with 2 laydown style master cylinders P/N 06-16860\$659.00

AVAILABLE SEPARATELY:

6" Wheel & Brake.....P/N 06-16810\$446.00
5" Nose wheel with 5/8" BearingsP/N 06-16820\$79.00
A-4 Axle, 9.75" Long, 5/8" Dia.P/N 06-16830\$40.00

JDM WHEELS, BRAKES AND AXLES

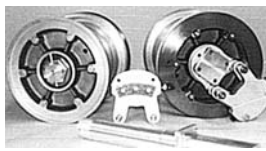

A quality built 6" wheel & brake designed for the homebuilt and ultralight flyer. Rated up to 2500 lbs. gross weight, these wheels easily accommodate 800 series tires for off-field landings and 600 series tires for low profile and an increase in speed. The brake disks made of cast iron provide for longevity and superior heat dissipation, while using Rapco brake pads to finish the system. The axles are 1-1/4" aluminum and use a 1-3/8" square bolt pattern. The kit does not include master cylinders, brake fluid line or axles and nuts. Each JDM brake and wheel including the axle weigh only 10.3 lbs. Kit includes 1 wheel and 1 brake. 6" wheel & Brake Assembly* (1-1/4" Tapered Roller Bearing)

P/N 06-03475 ..\$505.95 ea
P/N 06-03480\$73.50 ea

1-1/4" Axle & Castle Nut

AZUSALITE NYLON WHEELS 4, 5 AND 6 INCH MODELS



Azusalite wheels are made from engineering grade Nylon which combines high tensile and compressive strengths and good impact resistance. Excellent for many homebuilt and ultralight aircraft applications since they weigh 60-70% less than aluminum wheels. Azusalite wheels are offered in 4", 5" and 6" models. Replacement parts and unlisted accessories available on request.

AZUSALITE 5" WHEEL – Used as the main wheels on the Mohawk ultralight, this 5 inch wheel features 5/8" I.D. sealed ball bearings and uses a 4.10 / 3.50 x 5 or 5.00 x 5 tire and tube.

P/N 06-02500\$19.80

AZUSALITE 4" WHEEL – A 4 inch Azusalite wheel featuring 5/8" sealed ball bearings. Uses a 4.10 / 3.50 x 4 tire and tube.

P/N 06-02600\$14.30

AZUSALITE 6" WHEEL – A 6 inch Azusalite wheel which comes complete with 5/8" sealed ball bearings. Uses a 4.10 / 3.50-6 or a 6.00-6 tire and tube.

P/N 06-02700\$23.80

AZUSA TIRES & TUBES (Sawtooth Tread)

4 .10 / 3.50 x 4 Tire & Tube Assembly....P/N 06-02800\$17.10 Ea
4 .10 / 3.50 x 5 Tire & Tube Assembly....P/N 06-02900\$18.75 Ea
4.10 / 3.50 x 6 Tire & Tube AssemblyP/N 06-03000\$20.75 Ea
4.80 x 4.00 x 8 Tire & Tube Assembly....P/N 06-03010\$17.05 Ea

AZUSA ALUMINUM WHEELS



5" AZUSA ALUMINUM WHEEL – Complete with 5/8" I.D. sealed bearings P/N 1144\$25.30

5" AZUSA ALUMINUM WHEEL & BRAKE KIT – Kit consists of (2) #1144 wheels with 5/8" sealed bearings, (2) #2270 aluminum Azusa brakes, (2) #2211 brake drums and two 11.400-5, 6-ply Lamb tires and tubes.P/N 06-03100\$179.85

5" AZUSA ALUMINUM WHEEL – Complete with 3/4" bearing.

P/N 06-00376\$33.85

6" AZUSA ALUMINUM WHEEL – Complete with 5/8" I.D. sealed bearings. Wt. 3.9 lbs.P/N 06-03200\$39.50

6" AZUSA ALUMINUM WHEEL – Complete with 5/8" I.D. Timken bearings. Wt. 4.1 lbs.P/N 06-03300\$51.75

6" AZUSA ALUMINUM WHEEL – Complete with 3/4" I.D. Timken bearings. Wt. 4.2 lbs.P/N 06-03400\$43.90

8" AZUSA ALUMINUM WHEEL & BRAKE KIT – Kit consists of (2) #1175 wheels, (2)#2530 brakes, (2)#2542 drums, (2)4.80 x 4.00 tires and tubes, & hardware.....P/N 06-03410\$189.70

AZUSA BRAKES FOR AZUSA 5" & 6" WHEELS

These 4.5" brakes have a long actuating arm, 5/8" mounting hole, and bonded lining. Available in anchor style w/ built-in anchor & 2 cable mounting ears, or round style which features a round aluminum backing plate. Platform required w/ 5" Azusalite.

P/N	Description	Price
06-03415	Anchor Style Brake #2208	\$33.50
06-03420	Round Style Brake #2270A	\$25.80
06-03425	Brake Arm #2263	\$1.16
06-03430	Spring #2264	\$0.75
06-03435	Cam #8235	\$4.80
06-03440	Platform #2259A	\$6.30
06-03445	Lined Shoes (1/side) #2260	\$15.70

AZUSA BRAKES FOR AZUSA 8" WHEELS

These 5" brakes are used on Azusa #1175 wheels only. Features a round aluminum backing plate and actuating arm which allows for 8 positions.

P/N	Description	Price
06-03450	Round Style Brake #2530	\$30.50
06-03455	Brake Arm #2537	\$3.10
06-03460	Spring #2539	\$0.55
06-03465	Cam #2533	\$6.70
06-03470	Lined Shoes (1/side) #2538	\$14.50

LG

WHEELS & BRAKES

GROVE 500 X 5 WHEEL & BRAKE SET



Manufactured by Grove Aircraft Company for experimental aircraft, these high quality wheels and brakes are manufactured to the highest aircraft standards. These wheels fit standard 500 x 5, 1.25" diameter axles. The brake calipers are CNC machined from aluminum bar stock. The brake discs are machined from solid steel for smoother braking. Static load rating is 1,250 Lbs. per wheel.

Grove #50-1AP/N 06-00094.....**\$579.00**

LIGHTWEIGHT 500 X 5 WHEEL & BRAKE SET

A lighter version of our popular 50-1A Wheel for aircraft with a gross weight of 1600 lbs. or less

- Fits Standard 500X5, 1-1/4" Axles
- Brake calipers utilize std bra and seals
- Brake Discs are machined from a forging
- Static Load Rating 800lbs/ wheel

Grove #51-1..P/N 06-00589.....**\$515.95**



GROVE HIGH PERFORMANCE 500 X 5 WHEEL & BRAKE SET



This high performance 500 x 5 wheel and brake set from Grove Aircraft is the better choice for heavy aircraft and/or aircraft with high landing speeds. They fit standard 500 x 5, 1.25" diameter axles. The dual piston brake calipers provide 36% more braking power and the larger brake pad area increases service life. The thicker brake disc absorbs more heat energy to reduce brake fade.

Grove #56-1P/N 06-00095.....**\$689.00**

GROVE ULTRA HIGH PERFORMANCE 500 X 5 WHEEL & BRAKE SET

The ultra high performance 500 x 5 wheel and brake set from Grove Aircraft is the ideal choice for heavier aircraft and/or aircraft with high landing speeds. The wheels accept standard 500 x 5, 1.25" diameter axles. The dual piston brake calipers provide 83% more braking power than the standard Grove 500 x 5 brakes. The larger brake pad area increases service life, the thickest Grove brake disc absorbs maximum heat energy to reduce brake fade.



Grove #57-1P/N 06-00096.....**\$749.00**



GROVE 500X5 NOSE WHEEL

This 500 x 5 nose wheel from Grove Aircraft fits a standard 1.25" axle and is a standard replacement for many popular homebuilt aircraft. It is CNC machined from 356-T6 aluminum castings and includes Timken tapered roller bearings.

Grove #59-1A..P/N 06-00102.....**\$229.00**



GROVE 600X6 NOSE WHEEL

This 600 x 6 nose wheel fits a standard 1.5" diameter axle and is a standard replacement for many popular homebuilt aircraft. It is CNC machined from 356-T6 aluminum castings and includes Timken tapered roller bearings.

Grove #69-1P/N 06-00103.....**\$279.00**

LANCAIR 320 WHEEL & BRAKE SET



Upgrade your Lancair 320 with high performance wheels and brakes. This set will provide better braking power, longer brake pad life, felt dust seals and dual piston calipers. The kit includes special axles and spacers. Brake pad replacement does not require wheel removal.

Grove #56-3AP/N 06-00098**\$699.00**

LANCAIR NOSE WHEEL UPGRADE KIT - Includes wheel with felt seals and axle spacers. Grove #59-3AP/N 06-00099**\$234.95**

GROVE 600 X 6 WHEEL & BRAKE SET

Grove Aircraft manufactures these high quality 600 x 6 wheels and brakes for heavier experimental aircraft. The wheels fit standard 600 x 6, 1.5" diameter axles. The brake calipers are CNC machined from aluminum bar stock and the brake discs are machined from solid steel for smoother braking. Static load rating is 1,750 lbs./wheel



Grove #60-1P/N 06-00101.....**\$819.00**

GROVE 600 X 6 WHEEL & BRAKE SET

For Heavier experimental aircraft, Grove Aircraft manufactures these high quality 600x6 wheels & brakes. • Fits Standard 600x6 1-1/2" Axles • Brake Calipers utilize standard brake pads and O-ring seals • Brake Discs are machined from a 1 piece forging & heat-treated for longer life • Static Load Rating 1250lbs / Wheel



Grove #61-1P/N 06 00590.....**\$660.95**

LIGHTWEIGHT 600 X 6 WHEEL & BRAKE SET



This is the ideal wheel for Cub-type aircraft. Fits standard cub axles or use with our "bolt-on" 5015 axle. • Fits 1-1/4" Cub-type Axle • Brake Calipers utilize standard brake pads and O-ring seals • Brake Discs are machined from a 1- piece forging & heat-treated for longer life • Static Load Rating 1250lbs. per wheel.

Grove #65-1 P/N 06-00591.....**\$678.95**

LIGHTWEIGHT 600 X 6 WHEEL & BRAKE SET



The new FAA/PMA approved disc brake conversion for Goodrich wheels and brakes only. It has been specifically designed to be easily adapted to aircraft in the field by a qualified Airframe Mechanic.

- Maintain the classic cub look.
- Improved Braking and Handling.
- Use your existing wheels, tires and tubes.
- Use your existing master cylinder and brake lines.
- Easy installation—all parts & special tools included.

P/N 0600591.....**\$678.95**

GROVE SLIMLINE MASTER CYLINDER

Model#670-3

This Grove master cylinder uses a remote reservoir (not included) and can be used on many popular homebuilts. Pin center length is 7.5", bore is 5/8", stroke is 1.4", & ports at 1/8" NPT. Wt: 10oz.

Model#670-3 has exit port offset 90° from lower attach hole. P/N 06-00104**\$129.95**

Model#670-1 has exit port aligned w/lower attach hole. P/N 06-00594**\$129.95**

Model#670-17 has exit port aligned w/lower attach hole. P/N 06-00597**\$129.95**

Model#670-15 has exit port offset 90° from lower attach hole. P/N 06-00596 ..**\$129.95**

GROVE MASTER CYLINDER W/ RESERVOIR

Model#675-1

This Grove master cylinder features a builtin reservoir which holds 1.2 oz. of brake fluid. Pin center length is 8", bore: 5/8", stroke:1.2", and outlet port: 1/8" NPT. Wt: 10 oz.

Model#675-1 has exit port aligned w/lower attach hole. P/N 06-00097 ..**\$139.95**

Model#675-3 has exit port offset 90° from lower attach hole. P/N 06-00593 ..**\$139.95**

LG

BRAKE PARTS – DISCS



METAL HUB CAPS

These FAA approved metal hub caps are designed for older Pipers using the 800x4 Goodrich (Hayes) brakes such as the J-3 and PA-18. A larger cap for 600 x 6 conversions are also available below. The caps are available with "CUB" stamped in raised letters or plain.

- Cub 800x4 Goodrich hub capP/N 06-00010**\$24.50 ea.**
- Cub 600x6 Cleveland hub capP/N 06-00020**\$24.90 ea.**
- Plain 800x4 Goodrich hub capP/N 06-00030**\$22.70 ea.**
- Plain 600x6 Cleveland hub capP/N 06-00040**\$26.30 ea.**



WHEEL COVERS

For Gerdes, McCauley, Cleveland, Hayes, Goodyear, Rosenhan and Matco wheels as listed. Furnished with mounting screws and lock washers.

P/N	Wheel Size	Application	Price ea.
157-8	5.00-5*	Cleveland, McCauley, Gerdes	\$41.75
157-9	6.00-6**	Cleveland, McCauley, Gerdes	\$30.65
06-03705	6.00-6	All Goodyear Wheels	\$26.90
06-03800	8.00-4	All Hayes Wheels	\$24.85
06-03900	5" Dia.	Rosenhan Matco Wheels	\$7.10

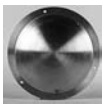

ECONOMY WHEEL COVER

For 600-6 Cleveland wheels ..P/N 06-03710.....**\$8.52 ea.**
 For 500-5 Cleveland wheels ..P/N 06-00073.....**\$14.77 ea.**
Furnished with screws for installation

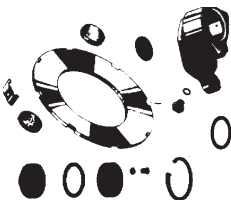

GOODYEAR BRAKE PARTS

Most replacement parts are available for aircraft still equipped with Goodyear wheels and brakes. We provide prompt shipment on replacement parts such as brake linings, brake discs, clips, etc. Request quotation on any unlisted Goodyear part numbers.

- Brake 5.00 x 5, Cessna 150, Assy. No. 9532302**
 - 5010727Anvil Lining**\$155.00 ea.**
 - 9524161-1Piston Lining.....**\$82.95 ea.**
- Brake 6.00 x 6, Cessna 120, 140, Aeronca 7AC, 11AC, Swift, Luscom., Assy. No. 9520517**
 - 9511261-1Anvil/Piston Lining.....**\$172.50 ea.**
 - 9523482Disc Clips**\$159.95 ea.**
- Brake 6.00 x 6, Cessna 120, 140, Swift, Luscombe, Sedan, Aeronca 11AC, Assy. No. 9520298**
 - 501482.....Piston Lining.....**\$69.95 ea.**
 - 9520435Disc Clips, 4 required.....**\$69.75 ea.**
- Brake 6.00 x 6, Cessna 172, 175, 180, 182, 210, Lake, Assy. No. 9532181**
 - 9511271-2Anvil Lining**\$279.95 ea.**
 - 9511269-2Piston Lining**\$177.95 ea.**
- Brake 6.00 x 6, Cessna 170, 172, 175, 180, 182, 210 Assy. No. 9530839 Aeronca 7AC, 11AC, 15AC, Stinson 150, 165, Assy No. 951239 & 9532181**
 - 9511271-2Anvil Lining**\$279.95 ea.**
 - 9511269-2Piston Lining**\$177.95 ea.**
 - 9523482Disc Clip.....**\$159.95 ea.**
- Brake 6.00 x 6, Aeronca 7AC, 11AC, Funk, Schweizer Glider, Luscombe 8,8A, Assy No. 9530131, Assy. No. 511254**
 - 9520435Disc Clips, 4 required.....**\$69.75 ea.**
- Brake 6.00 x 6, Ercoupe Forney, Assy. No. 9520285**
 - 9523482Disc Clip.....**\$159.95 ea.**
- Brake 6.50 x 8, Beech T34, 35, Camair, Assy. No. 511731**
 - 9510714-2Anvil Lining**\$174.65 ea.**
 - 9510713-1Piston Lining**\$195.95 ea.**
 - 9523937Disc Clip**\$26.80**
- Brake 6.50 x 10, Cessna 190, 195, 310, 320 Assy. No. 951731**
 - 5009853Piston Lining**\$195.95 ea.**
 - 95-10375.....Disc Clip, 5 required**\$7.70**

STAINLESS STEEL BRAKE DISCS FOR HOMEBUILTS



These two stainless steel brake discs can be retrofitted to all Glasairs, VariEzes, Long-EZs and other homebuilts using Cleveland 500 x 5 wheels and brakes. The Cleveland #164-85 disc can be directly replaced by the #201-85 stainless disc and the Cleveland #164-17 disc can be replaced by the #85 disc with the addition of spacers and caliper bolts included in the CK-5 conversion kit. These stainless discs are thicker, with thicker brake linings, to give you far superior braking and no corrosion to worry about. This stainless steel brake disc system can triple the life of your linings for a fraction more in cost than to replace the original discs. Highly recommended in "The Aviation Consumer" and "The 1987 Pilot's Yearbook". Sold in pairs only.

STAINLESS STEEL PART NO.	CLEVELAND PART NO.	PRICE PER PAIR
201-7SS	164-7	\$419.95
201-15SS	164-15A	\$466.95
201-85SS	164-85	\$351.95
Use 201-85 SS w/conv. kit CK-5	164-17	\$353.95

STAINLESS STEEL BRAKE DISCS FOR CERTIFICATED AIRCRAFT



These solid stainless steel brake discs were developed to eliminate the problem of rust associated with regular carbon steel discs and the cracking and peeling of chrome plated discs. The stainless discs provide excellent braking performance and improve brake component service life - brake pads will last much longer. The advantages of stainless discs are most pronounced in harsh environmental conditions. STC'd for Twin Comanche and Comanche 400 that do not use metallic linings. When ordering, please furnish part number of the disc being replaced and aircraft make, model and number.

LG

STAINLESS STEEL PART NO.	CLEVELAND PART NO.	PRICE PER PAIR
159-10SS	159-1	\$364.95
201-9SS	164-9	\$364.95
201-10SS	164-10***	\$479.95
201-19SS	164-19	\$420.95
201-120SS	164-20	\$364.95
202-22SS	164-22A**	\$478.95
201-25ASS	164-25A	\$478.95
201-25BSS	164-25B	\$478.95
201-195SS	B30195	\$420.95
201-440SS	B30440	\$364.95

***Must be used with organic linings, use conversion kit CK10 to convert from metallic linings.
 **Must be used with organic linings, use conversion kit CK220 to convert from metallic linings.

BX-1000 BLACK MAX HYDRAULIC BRAKE SYSTEM



(Everything you need in one package)

This system has a full floating rotor which compensates for alignment giving you a smooth feeling brake action. The master cylinder has a built in reservoir which allows you to add oil and bleed from the top down. Maximum holding pressure to allow for a good run up. Uses standard brake fluid. Gross rating 1000 lbs. **Features:** • Master Cylinder w/reservoir and brake handle • 2.6" polished aluminum wheels • 2 Hubs w/bearings • 2 Tires • 2 Rotors • 2 Calipers • 5/8" axle w/keyway • Brake Pads • 14' of Hydraulic Brake Line Fittings and Hardware.P/N 06-00707**\$389.00**

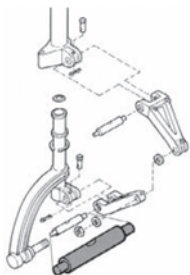

TOW PIN FOR BEECHCRAFT FAA/PMA approved

Installation Eligibility:

- Debonair:** 35-A33, 35-B33, 35-C33, E33, F33
- Bonanza:** G33, 35-C33A, E33A, F33A, F33C, N35, P35, S35, V35, V35A, V35B, 36, A36, A36TC, B36TC
- Baron:** 20-21-3 95-55, 95-A55, 95-B55, 59-C55, D55, E55, 58, 56TC, A56TC, 58TC, 58P
- Duke:** B60 P/N 05-01625**\$21.25**

BRAKE DISCS

CLEVELAND & RAPCO BRAKE DISCS

ALL THE BRAKE YOU NEED WITH A PRICE BREAK - A FULL 30% OR MORE OFF LIST PRICE!

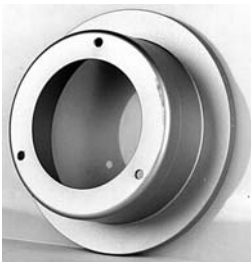

If your aircraft is flown a lot (more than 200 hours a year) and is not exposed to exceptionally corrosive atmospheres, Cleveland Standard discs are the ideal replacement when normal brake wear requires it.

Cleveland Chrome brake discs are the answer for owners of aircraft that are exposed to the elements (moisture, salt, industrial chemicals) and are not flown frequently enough to rub off corrosion. If you fly less than 200 hours a year, your aircraft spends more than 8,500 idle hours exposed to the elements. Standard and Chrome Cleveland brake discs are fully FAA approved as replacements on virtually all popular single engine aircraft.

WE WILL BEAT ANY COMPETITOR'S ADVERTISED PRICE ON CLEVELAND DISCS

Aircraft Model	Main Wheel Ass'y	Standard Disc	Our Price Each	Chrome Disc	Our Price Each	Rapco Standard Disc	Our Price Each
Homebuilts Homebuilts	500x5 40-78B 600x6 40-59A	164-17 164-75	\$111.95 \$102.95	164-117 164-175	\$191.95 \$198.95	RA164-01700 RA164-07500	\$77.00 \$71.00
Aeroteck (Pitts) S-1 Series, S-2A	500x5 40-78B	164-17	\$111.95	164-117	\$191.95	RA164-01700	\$77.00
Bonanza 33, 35, 36	600x6 40-83	164-02505	\$123.95	164-125B	\$198.95	RA164-02504	\$76.50
Bellanca Citabria, Decathlon Bellanca Champ Viking 300A	600x6 40-28D 600x6 40-78B 600x6 40-75E 600x6 40-15A	164-5 164-17 164-15A	\$99.95 \$111.95 \$122.95	164-105 164-117 164-115A	\$166.95 \$191.95 \$187.95	RA164-00500 RA164-01700 RA164-01501	\$72.50 \$77.00 \$79.50
Cessna 150C Cessna 150C,E Cessna 150F,G,H,J Cessna 150K Cessna A150K, F150, FA150 Cessna 152, F152, FA152	600x6 40-57 500x5 40-78 600x6 40-97A 600x6 40-97A 600x6 40-113	164-5 164-17 164-26A 164-26A 164-40	\$99.95 \$111.95 \$91.50 \$91.50 \$108.95	164-105 164-117 164-126A 164-126A 164-140	\$166.95 \$191.95 \$139.95 \$139.95 \$149.95	RA164-00500 RA164-00400 RA164-02601 RA164-02601 RA164-04000	\$72.50 \$81.00 \$62.85 \$62.85 \$76.85
Cessna 172	600x6 40-97A 600x6 40-113	164-26A 164-40	\$91.50 \$91.50	164-126A 164-126A	\$139.95 \$139.95	RA164-02601 RA164-02601	\$62.85 \$62.85
Cessna 177, 177RG, F177RG Cessna 177A, B Cessna 180	600x6 40-113 600x6 40-97A 600x6 40-75B 600x6 40-75D 600x6 40-66	164-40 164-26A 164-15A 164-63 164-7	\$108.95 \$91.50 \$122.95 --- \$121.95	164-140 164-126A 164-115A 164-163 164-107	\$149.95 \$139.95 \$187.95 --- \$192.95	RA164-04000 RA164-02601 RA164-01501 --- RA164-00700	\$76.85 \$62.85 \$79.50 --- \$79.50
Cessna 182H, J, K, L, M, N Cessna 182N Cessna 182J, K, L, N, Cessna 185, A, B	600x6 40-97A 600x6 40-113 600x6 40-75B 600x6 40-32 600x6 40-66	164-26A 164-26A 164-15A 164-7 164-7	\$91.50 \$91.50 \$122.95 \$121.95 \$121.95	164-126A 164-140 164-126A 164-107 164-107	\$139.95 \$149.95 \$139.95 \$192.95 \$192.95	RA164-02601 RA164-04000 RA164-01501 RA164-00700 RA164-00700	\$62.85 \$76.85 \$62.85 \$79.50 \$79.50
Cessna 185C, D, E Cessna A185E 1966 & Up 1969 & Up 1967, 1968 Cessna 188, A188 Cessna 205, 205A	600x6 40-75B 600x6 40-75D 600x6 40-66 600x6 40-66 600x6 40-75B 600x6 40-75B 600x6 40-75B 600x6 40-75B	164-15A 164-15A 164-36 164-7 164-15A 164-15A 164-15A 164-15A	\$122.95 \$122.95 \$118.95 \$121.95 \$122.95 \$121.95 \$122.95 \$122.95	164-115A 164-115A 164-136 164-107 164-115A 164-115A 164-107 164-115A	\$187.95 \$187.95 \$191.95 \$192.95 \$187.95 \$192.95 \$192.95 \$187.95	RA164-01501 RA164-01501 RA164-03601 RA164-00700 RA164-01501 RA164-00700 RA164-00700 RA164-01501	\$79.50 \$79.50 \$81.75 \$79.50 \$79.50 \$79.50 \$79.50 \$79.50
Cessna 206, U206A, TU206A & Turbo Cessna U206D, D & Turbo Cessna P206, A, TP206A Cessna P206, A, B, C, D, & Turbo	600x6 40-75 600x6 40-75D 600x6 40-75 600x6 40-75B	164-15A 164-36 164-15A 164-15A	\$122.95 \$118.95 \$122.95 \$122.95	164-115A 164-136 164-115A 164-115A	\$187.95 \$191.95 \$187.95 \$187.95	RA164-01501 RA164-03601 RA164-01501 RA164-01501	\$79.50 \$81.75 \$79.50 \$79.50

LG

REPLACEMENT DISCS & LININGS FOR CESSNA/McCAULEY WHEELS & BRAKES

Cessna Aircraft Model	Cessna/McCauley Wheel Assembly	Cessna/McCauley Brake Disc Assy.	Cleveland Brake Disc Assy.	Price
150, 150A	C163004-0104 C163003-0101 or C163001-0102 C163002-0101	B-30440 B-30195 B-30007	164-09200 164-09300 164-09400	\$93.00 \$89.50 -----
152, A152, F152, FA152	C163005-0101 or C163006-0101	C30615-1	164-08800	\$86.00
172,F172,R172,FR172	C163004-0104 C163003-0101 or C163003-0102 or C163004-0104 C163002-0101	B-30440 B-30195 B-30007	164-09200 164-09300 164-09400	\$93.00 \$89.50 -----
172, F172, 172RG	C163006-0101	C30615-1	164-08800	\$86.00
177 177RG	C163005-0101 C163005-0101 or C163006-0101	C30615-1 C30615-1	164-08800 164-08800	\$86.00 \$86.00
180, 185	C163004-0103 C163004-0101 C163006-0103 Std. C163006-0102 HD	C30414 C30388 C30615-3 C30615-2	164-09500 164-09700 164-09000 164-08900	\$247.95 \$98.25 \$113.95 \$95.75
182, F182	C163006-0101 or C163006-0103	C30615-1 C30615-3	164-08800 164-09000	\$86.00 \$113.95
R182, FR182, TR 182	C163006-0103	C30615-3	164-09000	\$113.95
U206-TU206	C163004-0102 C163004-0101 C163006-0103 Std. C163006-0102 HD	C30398 C30388 C30615-3 C30615-2	164-09600 164-09700 164-09000 164-08900	\$94.25 \$98.25 \$113.95 \$95.75
210, T210, P210	C163006-0103 C163006-0103	C30398 C30615-3	164-09600 164-09000	\$94.25 \$113.95



CLEVELAND PERFORMANCE GOLD DISCS

A new, enhanced corrosion resistant brake disc is now available from Cleveland. Laboratory tests confirmed that Cleveland Performance Gold Discs, when paired with Cleveland non asbestos linings, significantly improve disc and lining life.

Gold Part No.	Replaces Standard Disc	Replaces Chrome Disc	Price Each
08-12000	164-02000	164-12000	\$119.95
08-12601	164-02601	164-12601	\$116.95
08-14000	164-04000	164-14000	\$127.95

464-12000 Disc Used On Wheel Assembly:	464-12601 Disc Used On Wheel Assembly:	464-14000 Disc Used On Wheel Assembly:
40-86	40-97A	40-113
40-86A	40-97D	40-113X
40-86B	40-97E	
40-86E	40-97F	
40-88C		

BRAKE LININGS

CLEVELAND STANDARD ORGANIC BRAKE LININGS

Order by NEW Cleveland part number.
All Linings Include Rivets

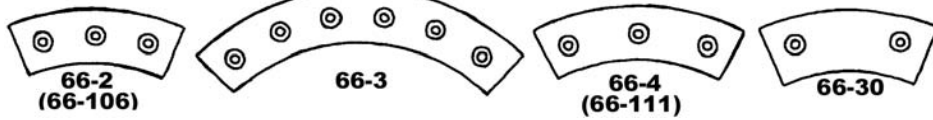

Aircraft Make & Model	Old Cleveland P/N	# Required	New Cleveland P/N	Price	Aircraft Make & Model	Old Cleveland P/N	# Required	New Cleveland P/N	Price
AEROTEK - Pitts S-1, S-2A	66-2	2	66-106	\$9.85	MOONEY - Most M20, A, B, D, E	66-4	2	66-111	\$14.40
BEECH - Musketeer	66-55	2	66-105	\$9.85	PIPER - Colt PA22-108	66-2	2	66-106	\$8.95
Sierra Sport Sundowner B-19; C-23, 24R	66-55	2	66-105	\$9.85		66-56	2	66-106	\$8.95
Debonair CD-1 thru CD-387	66-4	2	66-111	\$14.40	Apache PA-23-150, 160	66-2	2	66-106	\$8.95
Debonair B-33	66-2	2	66-106	\$8.95		66-56	2	66-106	\$8.95
BELLANCA - Citabria, Champ	66-2	2	66-106	\$8.95	Apache/Aztec PA-23-235, 250 Series	66-2	4	66-106	\$8.95
Scout	66-3	1	66-106	\$8.95		66-3	4	66-106	\$8.95
Decathalon, Scout 8GCBC	66-2	2	66-106	\$8.95	Comanche PA-24-180, 250, 260	66-2	2	66-106	\$8.95
Viking, Aries 250	66-55	2	66-105	\$9.85	Pawnee C PA-25	66-2	2	66-106	\$8.95
Skipper	66-71	2	66-112	\$14.85	Cherokee/Cruiser PA-28-140	66-2	2	66-106	\$8.95
CESSNA - 150A, B, C, D, E	66-2	2	66-106	\$8.95	PA-28-140 s/n 28-20521 & up	66-55	2	66-105	\$9.85
	66-56	2	66-106	\$8.95	Cherokee PA-28-150	66-2	2	66-106	\$8.95
150F, G, H, J, K, 152, F-152, FA-152	66-55	2	66-105	\$9.85	Cherokee PA-28-160 s/n 28-1761 & up	66-55	2	66-105	\$9.85
Skyhawk 172, Cardinal 177 All	66-55	2	66-105	\$9.85	Cherokee Warrior PA-28-151	66-55	2	66-105	\$9.85
Skywagon 180	66-55	4	66-105	\$9.85	Cherokee PA-28-160	66-2	2	66-106	\$8.95
Skylane 182 H, J, K, L, M, N	66-55	2	66-105	\$9.85	Cherokee/Warrior II PA-28-161	66-55	2	66-105	\$9.85
185A, B	66-2	2	66-106	\$8.95	Cherokee/Archer PA-28-180 to 28-1760	66-2	2	66-106	\$8.95
185C, D, E	66-55	2	66-105	\$9.85	Cherokee/Archer PA-28-180 28-1761 & up	66-55	2	66-105	\$9.85
185 with crosswind gear	66-2	2	66-106	\$8.95	Cherokee/Pathfinder PA-28-181, PA-28-236	66-55	2	66-105	\$9.85
AGWagon	66-55	4	66-105	\$9.85	PA-28R-180, PA-28-200	66-2	2	66-106	\$8.95
Stationair-6 205, 205A	66-2	2	66-106	\$8.95	PA-28R-180 s/n 28R-7130006 & up	66-55	2	66-105	\$9.85
Stationair-6 205, 205A (s/n 205-0481 & up)	66-55	4	66-105	\$9.85	PA-28-200 s/n 28R-7135110 & up	66-55	2	66-105	\$9.85
206, U206A, D, E & Turbo models	66-55	4	66-105	\$9.85	PA-28R-201T, 201, PA-28RT-201, 201T	66-55	2	66-105	\$9.85
207, T207	66-55	4	66-105	\$9.85	Early PA-28-235	66-56	2	66-106	\$8.95
210C	66-4	2	66-111	\$14.40	Early PA-28R-180, 200	66-56	2	66-105	\$9.85
210, P210, T210, 210N, P210N	66-55	4	66-105	\$9.85	Twin Comanche PA-30	66-19	2	66-62	\$17.40
305A, B, C, D, E, F	66-55	4	66-105	\$9.85	Navajo B, PA31-300, 310, Turbo Navajo	66-33	6	66-33	\$10.40
310, 335	66-33	6	66-33	\$10.40	Chieftain, PA-31-350	66-33	6	66-33	\$10.40
Skymaster 336	66-2	2	66-106	\$8.95	Cherokee/Six-260 PA-32-260	66-55	4	66-105	\$9.85
337, T337, 337B,C,D,E, T337B,C,D,E	66-55	4	66-105	\$9.85	PA-32-300 s/n 32-40000 thru 7200029	66-55	4	66-105	\$9.85
All Cessnas using Cessna/McCauley Brakes	B-30026	2			PA-32R-300, 32RT-300	66-55	4	66-105	\$9.85
GRUMMAN					PA-38-112 (6" wheel)	66-71	2	66-112	\$14.85
AA-1,A,B,AA-5,AA-5A,AA-5B,Tiger,TR-2	66-55	2	66-105	\$9.85	PA-38-112 (5" wheel)	66-56	2	66-106	\$8.95
AG-CAT	66-3	1	66-106	\$8.95	PA-39	66-19	1	66-62	\$17.40
	66-56	2	66-106	\$8.95	PA-39, PA-39-1 & up	66-3	1	66-106	\$8.95
G-154	66-2	2	66-106	\$8.95	PA-44-180	66-55	4	66-105	\$9.85
MAULE - Jetasen/Rocket, Lunar/Rocket	66-55	2	66-105	\$9.85	TAYLORCRAFT				
					Sportsman 100	66-55	2	66-105	\$9.85

*Advise aircraft make, model and serial number to assure that correct brake lining part number is furnished. ** Takes 2 each to replace: Extra rivets, P/N 105-2, for all models listed in table .05 each

BRAKE LINING TOOL



Designed especially to economically reline brakes, this riveting set is a handy tool for many other jobs where rivets are used to fasten leather, canvas, plastic and metal parts. Deluxe tool is screw-down type. Dlx. Brake Lining Tool..P/N 12-20810.....\$22.65
Brake Lining ToolP/N 824\$15.95
Brake Lining Rivets 4-4 P/N 105-2.....\$0.03
Brake Lining Rivets 4-6 P/N 06-02300.....\$0.03

BARRY JAY BRAKE LININGS

Clevid Equiv.	Part No.	\$/box of 8	Clevid Equiv.	Part No.	\$/box of 8
66-106	06-00147	\$39.36	66-111	06-00148	\$13.76
66-105	06-00193	\$19.95	66-108	06-00149	\$40.64
66-109	06-00150	\$40.64	66-103A	06-00146	\$38.24

Barry Jay Brake Linings are NOT FAA/PMA approved. Sold in boxes of 8 ONLY.

BARRY JAY GOODYEAR STYLE BRAKE PUCKS

Description	Part No.	Price/set	Description	Part No.	Price/set
Kidney Shape,thick	06-00151	\$14.60	1" Round, thin	06-00154	\$4.50
Kidney Shape,thin	06-00152	\$14.60	1.25" rnd,thick	06-00155	\$4.50
1" Round, thick	06-00153	\$4.50	1.25" round,thin	06-00156	\$4.50

NOT FAA/PMA approved. Sold in matched sets ONLY.

RAPCO REPLACEMENT BRAKE LININGS

As a RAPCO factory authorized distributor, Aircraft Spruce now offers these FAA-PMA approved brake lining replacements for Cleveland & McCauley brakes as an economical alternative to Cleveland factory linings. All are substantially discounted, with even further savings on quantity orders.

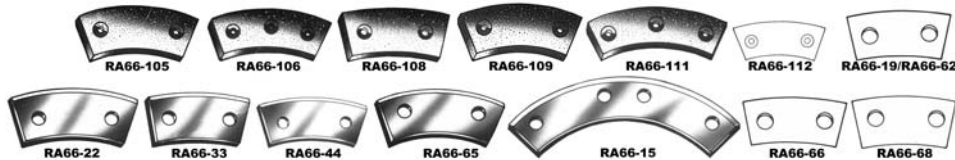

Our P/N 06-	Old Cleveland P/N	New Cleveland P/N	RAPCO P/N	Our Price Each	Our P/N 06-	Old Cleveland P/N	New Cleveland P/N	RAPCO P/N	Our Price Each
16956	66-2	66-106	RA66-106†	\$5.75	16956	66-56	66-106	RA66-106†	\$5.75
16956	66-3	66-106	RA66-106†	\$5.75	16956	66-57	66-106	RA66-106†	\$5.75
16958	66-4	66-111	RA66-111	\$6.95	16958	66-58	66-111	RA66-111†	\$6.95
16915	66-15	66-15	RA66-15	\$11.35	16959	66-59	66-108	RA66-108†	\$8.60
16919	66-19	66-19	RA66-19	\$6.30	16962	66-62	66-62	RA66-62	\$10.60
16922	66-22	66-22	RA66-22	\$6.90	16965	66-65	66-65	RA66-65	\$12.30
16955	66-30	66-105	RA66-105†	\$5.50	16966	66-66	66-66	RA66-66	\$10.50
16933	66-33	66-33	RA66-33	\$5.75	16968	66-68	66-68	RA66-68	\$13.90
16959	66-35	66-108	RA66-108†	\$8.60	16987	66-87	66-109	RA66-109†	\$7.95
16944	66-44	66-44	RA66-44	\$5.95	16987	66-88	66-109	RA66-109†	\$7.95
16955	66-55	66-105	RA66-105†	\$5.50					

* Use 2 each 66-106 linings to replace 1 each 66-3/66-57. ALL LININGS INCLUDE RIVETS
† Not for use on Stainless Steel Discs

RAPCO BRAKE LINING KITS

All Rapco Brake Lining kits come complete with correct number of linings and rivets needed for each aircraft.	Kit P/N	No. of linings	Kit Price
	RA66-105-4K	4	\$21.40
RA66-105-8K	8	\$44.95	
RA66-106-4K	4	\$19.50	
RA66-106-8K	8	\$39.95	
RA66-108-8K	8	\$65.50	
RA66-109-4K	4	\$29.95	
RA66-109-8K	8	\$59.95	
RA66-111-4K	4	\$25.95	

RIVETS

RAPCO P/N	Size	\$/ea.
RA105-00200-Countersunk Head	7/32" Long	\$0.14
RA105-00700-Flat Head	1/4" Long	\$0.16

WHEELS & BRAKES

FAA-APPROVED CLEVELAND WHEELS & BRAKES

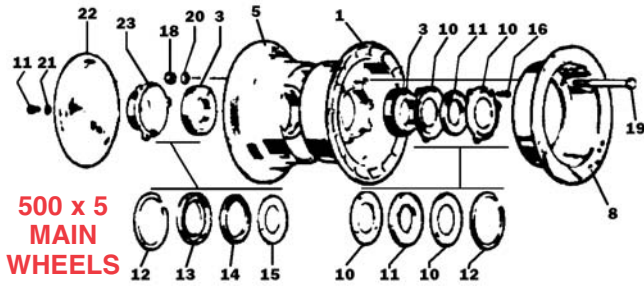

**500 x 5
MAIN
WHEELS**

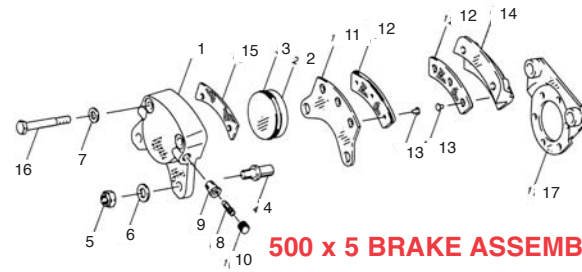

500 x 5 BRAKE ASSEMBLIES

FIG	CLEVELAND PART NUMBER	PART NUMBER	DESCRIPTION	ASSEMBLY NUMBER	QTY. PER ASSY.						PRICE EACH	
					40-12	40-12A	40-12B	40-19	40-19A	40-19B		40-78
1	161-5	161-00500	Inner Wheel Half Assy.	1	1	1						\$427.95
	161-01500	161-01500	Inner Wheel Half Assy.				1	1	1			\$98.75
	161-03100	161-03100	Inner Wheel Half Assy.							1		\$595.00
	161-04100	161-04100	Inner Wheel Half Assy.								1	\$164.95
3	08231	214-00300	Cup-Bearing	1	1	1	1	1	1	1	1	\$9.90
5	162-00500	162-00500	Outer Wheel Half Assy.	1	1	1						\$236.95
	162-01400	162-01400	Outer Wheel Half Assy.				1	1	1			\$161.95
	162-02800	162-02800	Outer Wheel Half Assy.							1		\$198.95
	162-03900	162-03900	Outer Wheel Half Assy.								1	\$208.95
3	08231	214-00300	Cup-Bearing	1	1	1	1	1	1	1	1	\$9.90
*	217-00100	217-00100	Grommet								1	\$2.80
*	101-07200	101-07200	"O" Ring	1	1	1						\$0.76
8	164-00400	164-00400	Brake Disc Assy.	1	1	1	1	1	1			\$132.95
	164-17	164-01700	Brake Disc Assy.							1	1	\$111.95
*	08125	214-00400	Cone-Bearing	2	2	2	2	2	2	2	2	\$19.50
19	AN4-31A	103-10800	Bolt	3	3	3	3	3	3			\$0.62
	AN4-22A	103-10500	Bolt							3	3	\$0.32
20	AN960-416	095-10400	Washer		6	6	6	6	6	3	3	\$0.03
18	AN365-428A	094-10300	Nut	3	3	3	3	3	3	3	3	\$0.10
10	153-00800	153-00800	Ring-Grease Seal	2	2	4	2	2	4	4	4	\$5.80
12	155-00200	155-00200	Ring-Snap	2	2	2	2	2	2	2	2	\$6.80
11	154-00600	154-00600	Felt-Grease Seal	1	1	2	1	2	1	2	2	\$4.15
23	158-00500	158-00500	Cap-Hub	1	1		1	1				\$126.95
17	102-25100	102-25100	Screw	1	1	1	1	1	1			\$2.65
21	095-15400	095-15400	Washer-Lock	1	1	1	1	1	1			\$1.30
22	157-00500	157-00500	Shield-Dust	1		1						\$37.60

MODEL NO. 40-78 wheel with brake disc and 1-1/4" dia. bearings as used on Cessna 150. P/N 40-78\$474.95

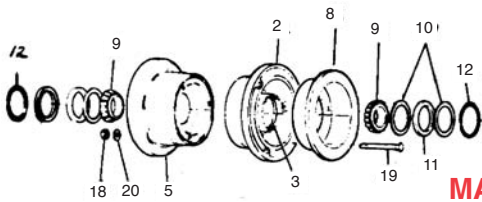

**600 x 6
MAIN WHEELS**

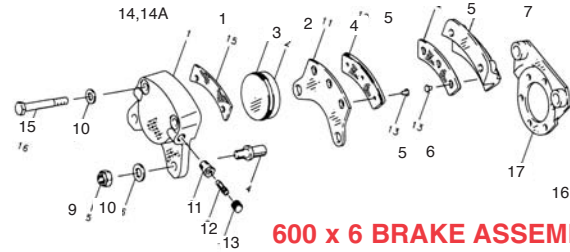

600 x 6 BRAKE ASSEMBLIES

FIG	Part Number	Cleveland Part Number	Description	ASSEMBLY NUMBER	Qty. Per Assembly					Price Ea.
					40-97	40-97A	40-97B	40-97C	40-97D	
2	161-03000	161-03000	Inner Wheel Half Assy.	1	1	1	1	1	1	\$183.95
	161-02100	161-02100	Inner Wheel Half Assy.						1	\$288.95
3	13836	214-00100	Cup-Bearing	1	1	1	1	1	1	\$15.90
5	162-02700	162-02700	Outer Wheel Half Assy.	1	1	1	1	1		\$182.95
	162-01900	162-01900	Outer Wheel Half Assy.						1	\$319.95
	13836	214-00100	Cup-Bearing	1	1	1	1	1	1	\$15.90
8	164-26A	164-02601	Brake Disc Assy.	1	1	1	1	1	1	\$91.50
	164-02800	164-02800	Brake Disc Assy.						1	\$110.95
9	214-00200	214-00200	Cone-Bearing	2	2	2	2	2	2	\$32.60
19	AN5-35A	103-20400	Bolt	3	3	3	3	3		\$1.24
	AN4-37A	103-11200	Bolt						6	\$0.89
20	AN960-516	095-10500	Washer	3	3	3	3	3		\$0.03
	AN960-416L	095-10200	Washer						6	\$0.03
18	AN365-524A	094-10400	Nut	3	3	3	3	3		\$0.15
	AN365-428A	094-10300	Nut						6	\$0.10
10	153-00400	153-00400	Ring-Grease Seal	2	2		2	2	2	\$6.40
	153-00300	153-00300	Ring-Grease Seal	1	1	2	1	1		\$5.20
	153-01500	153-01500	Ring-Grease Seal	1	1	2	1	1		\$8.95
	158-00300	158-00300	Cap-Hub						1	\$20.40
11	154-00300	154-00300	Felt-Grease Seal	1	1		1	1	1	\$3.95
	154-01300	154-01300	Felt-Grease Seal	1	1	2	1	1		\$4.25
12	155-00100	155-00100	Ring Snap	2	2	2	2	2	2	\$5.40

MODEL NO. 40-97A wheel with brake disc and 1.5" dia. bearings fits Cessna 172, 182 P/N 40-97A\$473.95

FIG	CLEVELAND PART NUMBER	PART NUMBER	DESCRIPTION	ASSEMBLY NUMBER	QTY. PER ASSY.				PRICE EACH
					30-56	30-56A	30-63	30-63A	
	091-02200	091-02200	Cylinder Assy.	1	1	1	1	1	\$305.95
1	061-01900	061-01900	Cylinder	1	1	1	1	1	\$141.95
2	062-01600	062-01600	Piston	1	1	1	1	1	\$28.80
3	101-05200	101-05200	"O" Ring	1	1	1	1	1	\$0.36
	073-01100	073-01100	Press. Plate Assy.	1	1	1	1	1	\$49.75
4	063-01200	063-01200	Plate-Press.	1	1	1	1	1	\$29.90
5	66-105	66-105	Lining	1	1	1	1	1	\$9.85
6	RA105-00200	RA105-00200	RIVET	2	2	2	2	2	\$0.14
	074-01000	074-01000	Back Plate Assy.	1	1	1	1	1	\$83.25
7	064-01500	064-01500	Plate-Back	1	1	1	1	1	\$53.25
5	66-105	66-105	Lining	1	1	1	1	1	\$9.85
6	RA105-00200	RA105-00200	Rivet	2	2	2	2	2	\$0.14
8	069-00400	069-00400	Bolt-Anchor	2	2	2	2	2	\$13.30
9	AN365-428A	094-10300	Nut	2	2	2	2	2	\$0.10
10	AN960-416L	095-10200	Washer	4	4	4	4	4	\$0.03
11	081-00100	081-00100	Seat-Bleeder	1	1	1	1	1	\$9.30
12	079-00300	079-00300	Screw Bleeder	1	1	1	1	1	\$7.10
13	183-00100	183-00100	Cap-Bleeder	1	1	1	1	1	\$1.53
14	AN823-4D	104-00500	Fitting Tube	1	1				\$3.70
15	LP4-17AM	103-11600	Bolt-Lock	2	2	2	2	2	\$0.42
15	AN4H-17A	103-11600	Bolt-Lock		2				\$0.42
16	075-01600	075-01600	Torque Plate Assy.	1					\$117.50
16	075-03700	075-03700	Torque Plate Assy.			1	1	1	\$95.50
17	145-01000	145-01000	Bushing	2		2	2	2	\$6.90

MODEL NO. 30-63A used with wheel 40-97A P/N 30-63A\$325.95

LG

AIRCRAFT SPRUCE WEST
CORONA, CA • (877) 4-SPRUCE

230
Prices Subject to Change Without Notice

AIRCRAFT SPRUCE EAST
PEACHTREE CITY, GA • (877) 477-7823

AIRCRAFT TIRE APPLICATION CHART

Tires/Tubes Certified Aircraft Application Chart - Tires are low speed unless designated. Tires are tube-type unless otherwise indicated. Consult aircraft manual for individual tire pressure. - **IMPORTANT: READ THIS LEGEND FIRST** -

Code: TL = Tubeless; SC = Smooth Contour; DT = Deflector Type; DDT = Dual Deflector Type

APPLICATION CHARTS - The application information presented within this manual is based on the most current information available and is intended for use as a **GENERAL REFERENCE ONLY**. Any inquiries regarding specific model aircraft should be directed to the applicable airframe manufacturer. Your requirements may vary depending on the actual configuration of your aircraft. All Goodyear aircraft tires are manufactured in accordance with TSO-C62, MIL-T-5041 or AIR8505A and/or applicable airframe manufacturer specifications. Additionally, all tire sizes included in this manual may not necessarily be available from Goodyear. Contact your Goodyear Representative for specific tire information and availability. **Failure to make this verification and to install unapproved tires on an aircraft may result in tire failure causing property damage, serious injury, or loss of life.**

CESSNA

Model	Name	Main Tire		Auxiliary Tire	
		Tire Size	Ply	Tire Size	Ply
120, 140	—	6.00-6	4	5.00-5	4
150, 152	Commuter, Aerobat	6.00-6	4	5.00-5	4
172	Skyhawk	6.00-6	4	5.00-5	4
R172	Hawk XP	6.00-6	4	5.00-5	4
172 Q	Cutlass	6.00-6	6	5.00-5	4
172 RG	Cutlass RG	15x6.00-6	6	5.00-5	4
175	Skylark	6.00-6	4	5.00-5	4
177	Cardinal	6.00-6	6	5.00-5	4
177 RG	Cardinal RG	15x6.00-6	6	5.00-5	4
180	Skywagon	6.00-6	6	8.00"SC	6
182, T182	Skylane	6.00-6	6	5.00-5	6
182RG, T182RG	Skylane	15x6.00-6	6	5.00-5	4
185	Skywagon	6.00-6	6	8.00 SC	8
188	AG Wagon	22x8.00-8	6	10.00 SC	6
188	AG Wagon(optional)	8.50-10	6	10.00"SC	8
205	—	6.00-6	6	5.00-5	6
206	Station Air	6.00-6	6	5.00-5	6
206, 207	Optional	8.00-6	6	6.00-6	4
207	Skywagon	6.00-6	8	6.00-6	8
208 (FLO)	Caravan	8.50-10	8	22x8.00-8	6
208 (STA)	Caravan	6.50-10	8	6.50-8	8
210	Centurion	6.00-6	8	5.00-5	6
T210, P210	Turbo, Centurion	6.00-6	8	5.00-5	10
T303	Crusader	6.00-6	8	6.00-6	6
T303	Optional	6.50-8	8	6.00-6	6
310, T310	—	6.50-10	6	6.00-6	4
320, 340	—	6.50-10	6	6.00-6	4
336	—	6.00-6	6	15x6.00-6	6
337	Super Skymaster	18x5.5	8	15x6.00-6	6
401, 402	—	6.50-10	8	6.00-6	6
404	Titan	22x7.75-10	10TL	6.00-6	6
411	—	6.50-10	8	6.00-6	6
414	Chancellor	6.50-10	8	6.00-6	6
421	Golden Eagle	6.50-10	8	6.00-6	6
425	Conquest I	6.50-10	10	6.00-6	6

BELLANCA

Model	Name	Main Tire		Auxiliary Tire	
		Tire Size	Ply	Tire Size	Ply
260A	Bellanca	6.00-6	6	6.00-6	4
17-30A	Viking	6.00-6	6	15x6.00-6	6/8
17-31A	Super Viking	6.00-6	6	15x6.00-6	6/8
17-31ATC	Turbo Viking	6.00-6	6	15x6.00-6	6/8
7GCAA	Citabria	6.00-6	4	5.00-5	4
7KCAB	Citabria	7.00-6	4	5.00-5	4
8KCAB	Decathlon	8.00-6	4	5.00-5	4
8GCBC	Scout	8.50-6	4/6	5.00-5	4

MOONEY

Model	Name	Main Tire		Auxiliary Tire	
		Tire Size	Ply	Tire Size	Ply
MO-20	Ranger	6.00-6	6	5.00-5	4/6
MO-21C	Super	6.00-6	6	5.00-5	4/6
MO-22	Mustang	6.00-6	6	15x6.00-6	6
MO-20E	Chapparal	6.00-6	6	5.00-5	4
MO-20F	Executive	6.00-6	6	5.00-5	6
MO-20J	201	6.00-6	6	5.00-5	6
MO-20K	Turbo 231	6.00-6	6	5.00-5	6
M-20K	TSE	6.00-6	6	5.00-5	4
M-20M	Bravo	6.00-6	6	5.00-5	6
M-20S	Eagle	6.00-6	6	5.00-5	6
M-20R	Ovation	6.00-6	6	5.00-5	6

COMMANDER AIRCRAFT

Model	Name	Main Tire		Auxiliary Tire	
		Tire Size	Ply	Tire Size	Ply
112	Commander	6.00-6	6	5.00-5	4
112B	—	7.00-6	6	5.00-5	4
112TC, TCA	—	7.00-6	6	5.00-5	6
114	—	7.00-6	6	5.00-5	6
114A, B	—	6.00-6	6	5.00-5	6

BEECH

Model	Name	Main Tire		Auxiliary Tire	
		Tire Size	Ply	Tire Size	Ply
C-17R	Staggerwing	7.50-10	6	10.00SC	—
BE 18	Twin Beech	11.00-12	8 TL	14.50SC	8TL
BE 18H	Twin Beech	8.50-10	8 TL	8.50-10 8TL	
BE 19	Musketeer Sport	6.00-6	4	6.00-6	4
BE 23	Musketeer	6.00-6	4	6.00-6	4
BE23C, BE-A24	Sundowner	6.00-6	4	6.00-6	4
BE 24-R	Super Sierra	6.00-6	4	5.00-5	4
BE 33A	Bonanza	7.00-6	6	5.00-5	4
BE 35	Bonanza	7.00-6	6	5.00-5	4
BE 36	Bonanza	7.00-6	6	5.00-5	4
BE 50	Twin Bonanza	8.50-10	6	6.50-10 4	
BE B55	Baron	6.50-8	8	5.00-5	6
BE C55	Baron	6.50-8	8	5.00-5	6
BE E55	Baron	6.50-8	8	5.00-5	6
BE 58	Baron	6.50-8	8	5.00-5	4
BE 60	Duke	19.5x6.75-8	10TL	15x6.00-6	4
BE 65	Queen Air	8.50x10	8TL	6.50-10 6TL	
BE-80	Queen Air	8.50-10	8TL	6.50-10 6TL	
BE-C90B	King Air	8.50-10	8TL	6.50-10 6TL	
BE-B200	Super King Air	18x5.5	10TL	22x6.75-10	8TL
BE-200T	Super King Air	22x6.75-10	8TL	22x6.75-10	8TL
BE-99	—	18x5.5	8 TL	6.50-10 6TL	
BE-300/350	Super King Air	22x6.75-10	8TL	19.5x6.75-8	10TL
BE-2000	Starship 1	H19.5x6.75-10	8 TL	19x6.75-8	10TL

PIPER

Model	Name	Main Tire		Auxiliary Tire	
		Tire Size	Ply	Tire Size	Ply
J3	Cub	8.00-4	4	8.00"SC Solid	6
PA18-135	Super Cub	6.00-6	4	8.00"SC Solid	6
PA18-150	Super Cub	6.00-6	4	6x2.00	Solid
PA22	Tri Pacer	6.00-6	6	6.00-6	4
PA23, 160-235	Apache	7.00-6	6	6.00-6	4
PA23-250	Aztec	7.00-6	8	6.00-6	4
PA24-180	Commanche	6.00-6	4	6.00-6	4
PA24, 250, 260, 400	Commanche	6.00-6	6	6.00-6	4/6
PA25-150	Pawnee	7.00-6	4	8x3.00-4	4
PA25, 236, 260	Pawnee	8.00-6	4	8x3.00-4	4
PA28R-201	Arrow	6.00-6	6	5.00-5	4
PA28-140	Cherokee	6.00-6	4	6.00-6	4
PA28-150	Cherokee	6.00-6	4	6.00-6	4
PA28-151, 161	Warrior	6.00-6	4	5.00-5	4
PA28-160	Cherokee	6.00-6	4	6.00-6	4
PA28-180	Cherokee	6.00-6	4	6.00-6	4
PA28-181	Archer	6.00-6	4	5.00-5	4
PA28-235	Cherokee	6.00-6	4	6.00-6	4
PA30	Twin Commanche	6.00-6	4	6.00-6	6
PA31	Navajo	6.50-10	8	6.00-	6
PA31	Chieftain	6.50-10	8	6.00-6	6
PA31T	Navajo	6.50-10	10	6.00-6	6
PA31P	Pressurized Navajo	6.50-10	8	6.00-6	6
PA31T-500	Cheyenne 1A	6.50-10	10	6.00-6	6
PA32	6-300	6.00-6	6	6.00-6	6
PA32RT300	Lance	6.00-6	8	6.00-6	4
PA31P-350	Mojave	6.50-10	8	17.5x6.25-6	10
PA34-220	Seneca	6.00-6	8	6.00-6	6
PA36	Brave	8.50-10	6	10x3.5-4	6
PA38	Tomahawk	6.00-6	6	5.00-5	6
PA42	Cheyenne IIIA	6.50-10	12 TL	17.5x6.25-6	10
PA44-180	Seminole	6.00-6	6	6.00-6	6
600/601B (PA60)	Aerostar	6.50-8	TL	6.00-6	6
601P (PA60-601P)	Aerostar	6.50-8	8 TL	6.00-6	6
602P (PA60-602P)	Aerostar	6.50-8	8 TL	6.00-6	6
700P (PA60-700P)	Aerostar	6.50-8	8 TL	6.00-6	6
PA46-350P	Malibu Mirage	6.00-6	8	5.00-5	6
PA34-270T	Seneca V	6.00-6	8	6.00-6	8
PA44-180	Seminole	6.00-6	8	5.00-5	6
PA32R-301	Saratoga II HP	6.00-6	8	5.00-5	6
PA32R-301T	Saratoga II TC	6.00-6	8	5.00-5	6
PA28-181	Archer III	6.00-6	4/6	6.00-6	4
PA28-161	Warrior III	6.00-6	4	5.00-5	4

MAULE

Model	Name	Main Tire		Auxiliary Tire	
		Tire Size	Ply	Tire Size	Ply
MX-7-160	—	7.00-6	4/6	280/250-4	4
MXT-7-160	—	7.00-6	4/6	280/250-4	4
M-8-235	—	7.00-6	4/6	280/250-4	4
MX7-420	—	7.00-6	4/6	280/250-4	4



TIRES & TUBES

GOODYEAR



Flight Custom III Flight Special

FLIGHT CUSTOM III TIRES

Goodyear Flight Custom III Tires feature: Wingstay® formulation to reduce cracking • Deeper Tread Depth • Extra-wide Aquachannels • Kevlar® belt package • Premium Wingstay® formulation • Dual polymer tread compound.

Get up to 20% more landings, superior wet traction, enhanced treadwear and penetration resistance, higher sunlight and ozone resistance and improved traction and treadwear compound.

Goodyear tubes are all one premium quality.

FLIGHT SPECIAL

Size	Ply	Part No.	Price
17.5-62.5-6	10	06-00202	\$149.00
18.5-5	8	06-00203	\$148.95
17.5-62.5-6	10	06-00204	\$177.00
17.5-62.5-6	6	06-00205	\$152.95
17.5-62.5-6	10	06-00206	\$508.00
17.5-62.5-6	6	06-00207	\$189.95
17.5-62.5-6	10	06-00208	\$116.95
17.5-62.5-6	8	06-00209	\$159.00
17.5-62.5-6	12	06-00210	\$219.00
17.5-62.5-6	4	06-00211	\$178.95
17.5-62.5-6	8	06-00212	\$173.95

Tube-Type Tire Size	Ply Rating	Tread Design	Wt. Each Lbs.	Tire Pressure PSI (a)	Max. Load Rating Lbs.(a)	Tire		Tube	
						Part No.	Price	Part No.	Price
5.00-4	6	Rib	3.8	55	1200	06-04700	\$189.95	06-04800	\$84.00
5.00-5	4	FLC III	4.8	31	800	06-04900-3	\$112.95	06-05000	\$57.25
5.00-5	6	FLC III	5.2	50	1285	06-05100-3	\$123.95	"	\$57.25
6.00-6	4	FLC III	7.6	29	1150	06-05200-3	\$145.95	06-05300	\$43.00
6.00-6	6	FLC III	7.6	42	1750	06-05400-3	\$138.95	"	\$43.00
6.00-6	8	FLC III	9.2	55	2350	06-05410-3	\$165.95	"	\$43.00
15x6.00-6	6	FLC III	7.5	68	1950	06-05500-3	\$119.95	06-05300	\$43.00
6.50-8	6	FLC III	12.6	51	2300	06-05600-3	\$172.95	06-05700	\$53.25
6.50-8	8	FLC III	12.2	75	3150	06-05800-3	\$184.95	"	\$53.25
6.50-10	6	FLC III	12.5	60	2770	06-05900-3	\$224.95	06-06000	\$46.75
6.50-10	8	FLC III	12.9	80	3750	06-06100-3	\$198.95	"	\$46.75
6.50-10	10	FLC III	17.4	100	4750	06-06110-3	\$254.95	"	\$46.75
7.00-6	6	FLC III	10.0	38	1900	06-06200-3	\$171.95	06-06300	\$48.80
7.00-6	8	FLC III	12.3	54	2550	06-06210-3	\$178.95	"	\$48.80
7.00-8								06-06500	\$53.95
8.00-4	4	Rib	8.8	24	1100	06-06600	\$208.95	06-00071	\$156.95
8.50-10	8	FLC III	22.9	55	4400	06-06900-3	\$278.95	06-07000	\$69.75

GOODYEAR FLIGHT SPECIAL III and RIB TIRES

Tube-Type Tire Size	Ply Rating	Wt. Each Lbs.	Tire Pressure PSI (a)	Max. Load Rating Lbs.(a)	Tire		Tube	
					Part No.	Price	Part No.	Price
5.00-5	4	4.1	31	800	06-07110	\$74.95	06-05000	\$57.25
5.00-5	6	4.5	49	1260	06-07100	\$76.75	"	\$57.25
6.00-6	4	7.6	29	1150	06-07200	\$96.75	06-05300	\$43.00
6.00-6	6	7.7	42	1750	06-07300	\$98.75	"	\$43.00
6.00-6	8	9.5	55	2350	06-07310	\$146.95	"	\$43.00
15x6.00-6	6	6.6	68	1950	06-07340	\$112.95	06-05300	\$43.00
6.50-8	8	12.2	75	3150	06-07320	\$134.95	06-05700	\$53.25
7.00-6	6	8.7	38	1900	06-07330	\$115.95	06-06300	\$48.80
8.00-6	6	10.5	35	2050	06-06800	\$118.95	06-06300	\$48.80

Goodyear Tube w/TR67 90° valve – Will fit 15x600 & 600x6 Tires P/N 06-05305 **\$91.50**

LG



MICHELIN® AVIATOR® TIRES

The Michelin Aviator tire has many of the same features found on the top-of-the-line Michelin AIR. Like the Michelin AIR, the Aviator offers exceptional balance, a new sidewall configuration and an extra strong nylon casing. Also features tough MX1000 tread compound for long life, and a specialized sidewall compound to protect against ultraviolet light. And since it is available at a very attractive price, you'd be hard pressed to find a better tire for the money.

MICHELIN AIRSTOP TUBES

Tube Size	Part No.	Price
500x5	06-00019	\$52.75
600x6	06-00021	\$48.40

MICHELIN AVIATOR TIRES

Tire Size	Ply Rating	Part No.	Price ea	Tire Size	Ply Rating	Part No.	Price ea
500x5	6 ply	06-00016	\$77.00	650x8	8 ply	06-00315	\$137.95
600x6	4 ply	06-00017	\$92.75	700x6	6 ply	06-00316	\$111.95
600x6	6 ply	06-00018	\$126.00	15/600x6	6 ply	06-00308	\$188.95
600x6	8 ply	06-00314	\$106.95				

MICHELIN AIR TIRES

Tire Size	Ply Rating	Part No.	Price ea	Tire Size	Ply Rating	Part No.	Price ea
500x5	6 ply	06-08052	\$128.95	650x10	8 ply	06-08065	\$235.95
600x6	8 ply	06-08058	\$170.95	650x8	8 ply	06-08070	\$187.95
700x6	6 ply	06-08059	\$177.95	700x6	8 ply	08-08075	\$182.95
850x8	8 ply	06-08060	\$132.95	600x6	6 ply	08-08080	\$143.95

CONDOR TIRES

Available in a variety of sizes for light to medium general aviation aircraft that have a max. ground speed of 120mph on the runway. All tires are tube type for use with Michelin, Goodyear or McCreary tubes.



P/N	Size	Ply	Load	Price
06-08005	500x5	4	800	\$44.70
06-08010	500x5	6	1285	\$46.10
06-08015	600x6	4	1150	\$53.00
06-08020	600x6	6	1750	\$55.50
06-08025	600x6	8	2350	\$56.75
06-08030	700x6	6	1900	\$105.95
06-08035	700x6	8	2550	\$111.95
06-08040	15x600x6	6	1950	\$81.00
06-08045	800x6	6	2050	\$110.95
06-08050	800x6	8	2800	\$122.95
06-00195	500x5	10	--	\$64.25
06-00196	650x10	6	--	\$133.00
06-00197	650x10	8	--	\$158.95
06-00198	650x10	10	--	\$174.00
06-00199	650x8	8	--	\$124.00
06-00201	850x10	8	--	\$224.00

SHIN TIRES & TUBES

These industrial tires & tube assemblies from Goodyear and Shin are used on a unique variety of homebuilt & ultralight aircraft airplanes. Sold as set of tire & tube only.



Part No.	Size (shin)	Ply	Price
06-10830	4.10x3.50x4	4	\$19.55
06-10840	3.40x3.00x5	4	\$19.90
06-10850	4.10x3.50x5	2	\$20.35
06-10860	11x4.00x5	2	\$20.60
06-10870	15x6.00x6	2	\$32.80
06-10880	4.80x4.00x8	4	\$35.60

11.400 x 5 TIRES & TUBES

This tire fills the size gap between the 5.00-5 aircraft tire and the 3.40-5 industrial tire. Looks like a scaled-down 5.00-5. Fits VariEze, KR's and most experimentals using 5" wheels. Formerly known as Lamb tires, these are manufactured by Cheng-Shin.

11.400-5 (6 Ply) TireP/N 06-07400**\$19.95**
 11.400-5 (8 Ply) TireP/N 06-07500**\$19.95**
 11.400-5 TubeP/N 06-07600**\$9.95**



TIRES & TUBES FOR ULTRALIGHTS

TIRES					TUBES		
Part No.	Nom. Size	Width	Diameter	Price Ea.	Part No.	Size	Price
Ti006	300 x 4	3.2"	10.0"	\$10.40	Ti013	300x4	\$5.60
Ti005	400 x 5	3.9"	10.5"	\$10.60	Ti012	3.50x5	\$5.95
Ti001	400 x 6	4.1"	13.0"	\$15.40	Ti011	600x6	\$8.50
Ti004	500 x 6	4.8"	12.6"	\$22.90	Ti014	400x5	\$6.30
Ti002	600 x 6	5.9"	14.8"	\$25.00	Ti007	800x6	\$17.30
Ti003	800 x 6	6.0"	16.3"	\$65.25	Ti010	400 x 6	\$6.95
					Ti015	500 x 6	\$5.70

TIRE TALC

Eases installation of tubes in tires. 1 Lb.
 P/N 17-250**\$4.85**
DISCOUNT: LESS 15% ON 12

WHEELS & BRAKES

McCREARY TIRES & TUBES

Mfg. by Specialty Tires of America



These fine nylon cord tires with rib tread design are rigidly tested to meet FAA Standard TSO-C62. Air Trac tires are original equipment on many of today's aircraft and offer great performance in an economical tire. Air Hawk are premium grade tires, cost more but provide longer service life. Performance, construction, and safety you can count on from McCreary tires and tubes. Compare prices and get the best savings and faster service from Aircraft Spruce.

McCREARY "AIR TRAC" TIRES

Tube-Type Tire Size	Ply Rating	Wt./Lbs.	Tire Pressure PSI (a)	Max. Load Rating Lbs.(a)	Tire		Tube	
					Part No.	Price	Part No.	Price
5.00-5	4	4.4	31	800	06-08210	\$35.95	06-08300	\$46.85
5.00-5	6	4.3	50	1285	06-08200	\$37.80	"	\$46.85
6.00-6	4	6.8	29	1150	06-08400	\$39.95	06-08700	\$37.80
6.00-6	6	7.0	42	1750	06-08500	\$44.80	"	\$37.80
6.00-6	8	7.3	55	2350	06-08600	\$50.50	06-08700	\$37.80
15x6.00-6	4	6.3	45	1250	06-08800	\$68.00	06-08901	\$38.00
15x6.00-6	6	6.6	68	1950	06-08900	\$68.50	"	\$38.00
6.50-8	6	9.5	51	2300	06-09000	\$92.00	06-09200	\$43.30
6.50-8	8	10.0	75	3150	06-09100	\$97.25	"	\$43.30
6.50-10	6	10.7	60	2770	06-09300	\$104.95	06-09500	\$43.20
6.50-10	8	12.0	80	3750	06-09400	\$113.95	"	\$43.20
6.50-10	10	15.2	100	4750	06-09410	\$136.95	"	\$43.20
7.00-6	6	9.0	38	1900	06-09600	\$88.00	06-09800	\$38.30
7.00-6	8	9.4	54	2550	06-09700	\$94.75	"	\$38.30
7.50-10	6	14.3	46	3000	06-09710	\$166.95	06-09810	\$59.90
8.00-6	4	10.0	23	1350	06-09900	\$94.50	06-09800	\$38.30
8.00-6	6	10.3	35	2050	06-10000	\$95.50	"	\$38.30
8.50-6	6	16.5	30	2275	06-10100	\$137.95	06-10200	\$61.25
8.50-10	6	16.5	41	3250	06-10300	\$165.95	06-10500	\$66.50
8.50-10	8	19.5	55	4400	06-10400	\$190.95	"	\$66.50

The 7.00/8.00-6 tube can be utilized in both 7.00-6 and 8.00-6 tires.

McCREARY "AIR HAWK" TIRES

Tube-Type Tire Size	Ply Rating	Wt./Lbs.	Part No.	Price
5.00-5	4	3.8	06-07710	\$39.40
5.00-5	6	4.3	06-07700	\$38.90
6.00-6	4	6.8	06-07800	\$45.20
6.00-6	6	7.0	06-07900	\$45.50
6.00-6	8	7.8	06-07910	\$51.95
6.50-8	6	10.5	06-07912	\$96.00
6.50-8	8	10.5	06-07914	\$102.95
6.50-10	6	11.5	06-07916	\$110.95
6.50-10	8	11.8	06-07918	\$117.95
6.50-10 Special	8	14.5	06-00416	\$118.50
6.50-10	10	16.2	06-07920	\$142.95
7.00-6	6	9.5	06-07922	\$89.50
7.00-6	8	9.4	06-07924	\$94.90
8.00-6	4	10.4	06-07926	\$99.25
8.00-6	6	10.7	06-07928	\$97.00
800x6	8	11.8	06-07929	\$109.95
8.50-10	6	19.9	06-07932	\$186.95
8.50-10	8	23.3	06-07934	\$183.95
17.5/625-6	10	--	06-00309	\$89.00
18-5.5	8	--	06-00310	\$93.95
22/800-8	6	--	06-00311	\$113.95
29/1100-10	10	--	06-00312	\$357.95

McCREARY "SUPER HAWK" TIRES

These are premium light aircraft tires which provide a stiffer, heavier sidewall and more cut resistant tread. Nylon belted for flexibility and even wear with wide center rib for best runway contact.

Call for pricing on other sizes of Hawk Tires.

Part No.	Tire Size	Ply Rating	Price Ea
06-17000	5.00-5	6	\$78.50
06-18000	6.00-6	6	\$103.95
06-17500	6.50-10	8	\$155.95
06-17505	6.00-6	8	\$107.95
06-17510	6.50-10	10	\$162.95
06-17515	7.00-6	6	\$113.95
06-17520	7.00-6	8	\$118.95
06-17525	6.50-8	6	\$125.95
06-17530	6.50-8	8	\$124.95

McCREARY "AERO TRAINER" TIRES

Tube Type Tire Size	Ply	Part No.	Price Each
5.00-5	6	06-01700	\$37.40
6.00-6	6	06-01800	\$41.80

Aero Trainer Tires use standard McCreary tubes listed above

McCREARY AERO CLASSIC TIRES

Tire Size	Ply	Part No.	Price Ea.
27" AW	10	06-00080	\$417.95
27" Rib	10	06-00081	\$417.95
8.90x12.50 AW	6	06-00082	\$326.95
8.90x12.50 Rib	6	06-00083	\$288.95
17.00-16 T.T.	12	06-00084	\$914.00
5.00-150 T.T.	6	06-00085	\$143.95
4.00-150 T.T.	6	06-00086	\$143.95
11.00-12 TL	10	06-00087	\$419.95
8.00x260 T.T.	4	06-00088	\$348.95
380/150-5	6	06-00313	\$96.00
380x150-5 T.T. (15x6.00-5)	6	06-00089	\$86.50
420x150 T.T. (6.00x6.5)	4	06-00090	\$118.95

McCREARY TIRE & TUBE PACKAGES

600 X 6, 4 PLY KIT - Consists of three McCreary 600 x 6 4 ply tires and tubes. Fits PA-24-180 Comanche, PA-28 Cherokee, Beech Musketeer, Musketeer Sport, and Sundowner. W/Air Trac tiresP/N 06-21200.....**\$221.95**
W/Air Hawk tiresP/N 06-21205.....**\$226.95**

600 X 6, 6 PLY KIT - Consists of three McCreary 600 x 6 6 ply Air Trac tires and tubes. Fits Piper PA-44 Seminole, PA-30 Twin Comanche, and Cessna 337. W/Air Trac tiresP/N 06-21300.....**\$225.95**
W/Air Hawk tiresP/N 06-21305.....**\$230.95**

TWIN CESSNA KIT - Consists of two McCreary 6.00 x 10 6 ply tires and tubes and one 600 x 6 6 ply tire and tube. Fits Cessna 310. P/N 06-21400...**\$378.90**

6.00 X 6, 6 PLY / 5.00 X 5, 6 PLY KIT - Two McCreary 6.00 x 6, 6 ply tires and tubes and one 5.00 x 5, 6 ply tire and tube. Fits Cessna 182, 182N; all 206 Skylane, Skywagon, and Station Air 207; Mooney 201, 220; Waco 250 260, PA-32 6-300 Lance. W/Air Trac tiresP/N 06-21100.....**\$227.95**
W/Air Hawk tiresP/N 06-21105.....**\$233.95**

6.00 X 6, 4 PLY KIT - Two McCreary 6.00 x 6, 4 ply tires and tubes. Fits Bellanca Citabria 7ECA, 7GCA-A, 7GCBC and 7KCA-B. W/Air Trac tiresP/N 06-21110.....**\$147.95**
W/Air Hawk tiresP/N 06-21115.....**\$150.95**

6.00 X 6, 4 PLY / 5.00 X 5, 4 PLY KIT - Two McCreary 6.00 x 6, 4 ply tires and tubes and one 5.00 x 5, 4 ply tire and tube. Fits Beech Super/Musketeer Sierra; Cessna 150, 172, 175, 177; Grumman AA1B, AA5; PA-28, 151, 180R, 200R. W/Air Trac tiresP/N 06-21120.....**\$224.95**
W/Air Hawk tiresP/N 06-21125.....**\$228.95**

6.00 X 6, 6 PLY / 5.00 X 5, 4 PLY KIT - Two McCreary 6.00 x 6, 6 ply tires and tubes and one 5.00 x 5, 4 ply tire and tube. Fits Beech Debonair 33, 33A; Bonanza 33; Mooney 200, Mark 21C; Rockwell Commander. W/Air Trac tiresP/N 06-21130.....**\$227.95**
W/Air Hawk tiresP/N 06-21135.....**\$232.95**

6.00 X 6, 6 PLY / 6.00 X 6, 4 PLY KIT - Two McCreary 6.00 x 6, 6 ply tires and tubes and one 6.00 x 6, 4 ply tire and tube. Fits Bellanca 206, Viking; PA-24-250, 260, PA-32-260, 300. W/Air Trac tiresP/N 06-21140.....**\$223.95**
W/Air Hawk tiresP/N 06-21145.....**\$229.95**

6.50 X 10, 6 PLY / 6.00 X 6, 6 PLY KIT - Two Air Trac 6.50 x 10, 6 ply tires and tubes and one 6.00 x 6, 6 ply tire and tube. Fits Cessna 310 & 320. W/Air Trac tiresP/N 06-21150.....**\$354.95**

6.50 X 10, 8 PLY / 6.00 X 6, 6 PLY KIT - Two McCreary 6.50 x 10, 8 ply tires & tubes & one 6.00 x 6, 6 ply tire and tube. Fits Cessna 340, 401, 402, 411, 414, 421; PA-31-300, 310, 350, PA-31P-425. W/Air Trac tiresP/N 06-21155.....**\$368.95**
W/Air Hawk tiresP/N 06-21160.....**\$373.95**

7.00 X 6, 6 PLY / 6.00 X 6, 4 PLY KIT - Two McCreary 7.00 x 6, 6 ply tires and tubes and one 6.00 x 6, 4 ply tire and tube. Fits PA-23, 160, 235, 250. W/Air Trac tiresP/N 06-21165.....**\$308.95**
W/Air Hawk tiresP/N 06-21170.....**\$313.95**

8.50 X 6, 6 PLY KIT - Two Air Trac 8.50 x 6, 6 ply tires and tubes. Fits Bellanca Decathlon 8KCA-B and Scout 8GCBC. W/Air Trac tiresP/N 06-21175.....**\$372.95**



WHEELS & BRAKES

MATCO NOSE WHEELS

Matco Part No.	Our Part No.	Dia. (in.)	Bearing Axle dia.	Bearing Type Sealed	Width	Static Capacity (lbs.)	Load Limit (lbs.)	Weight (lbs.)	Price
MATERIAL: SPUN ALUMINUM									
MH6N	06-00537	6	0.625	Ball	5.325	660	2000	2.6	\$74.00
MH6N-S	06-00539	6	0.625	Ball	5.325	660	2000	2.6	\$74.00
MH6N.75	06-00538	6	0.75	Ball	5.325	660	2000	2.6	\$75.00
MH6N-S.75	06-00540	6	0.75	Ball	5.325	60	2000	2.6	\$75.00
MATERIAL: CNC CAST ALUMINUM									
NW40B	06-00541	4	6.25	Ball	3	660	2000	2.25	\$78.00
NW40B.75	06-00542	4	0.75	Ball	3	660	2000	2.25	\$78.00
NW40R	06-00543	4	0.75	Taper/Roll	3	1185	3560	2.25	\$112.00
NW50	06-00544	5	0.75	Taper/Roll	3.88	1185	3560	3.24	\$128.00
NW51	06-00545	5	0.75	Taper/Roll	3.88	1185	3560	3.24	\$128.00
NW501.25	06-00546	5	1.25	Taper/Roll	3.88	1420	4260	3.24	\$128.00
NW511.25	06-00547	5	1.25	Taper/Roll	3.88	1420	4260	3.6	\$128.00
NW60	06-00548	6	1.25	Taper/Roll	3.5	1420	4260	3.24	\$121.00
NW600	06-00549	6	1.25	Taper/Roll	4.5	1420	4260	3.24	\$131.00
MATERIAL: DIE CAST ALUMINUM									
NW40EE	06-00550	4	0.625	Ball	2.625	660	2000	1.65	\$43.00
NW50CC	06-00551	5	0.625	Ball	4.38	660	2000	2.7	\$74.00
NW50CC.75	06-00552	5	0.75	Ball	4.38	660	2000	2.7	\$74.00
NW51CC	06-00553	5	0.625	Ball	4.38	660	2000	2.7	\$74.00
NW51CC.75	06-00554	5	0.75	Ball	4.38	660	2000	2.7	\$74.00
NW50CC.75R	06-00555	5	0.75	Taper/Roll	4.38	1185	3560	2.8	\$118.00
NW51CC75R	06-00556	5	0.75	Taper/Roll	4.38	1185	3560	2.8	\$118.00
NW60CC	06-00557	6	0.625	Ball	4.38	660	2000	3.22	\$76.00
NW60CC.75	06-00558	6	0.75	Ball	4.38	660	2000	3.22	\$80.00
NW60CC.75R	06-00559	6	0.75	Taper/Roll	4.38	1185	3560	3.52	\$124.00
NW600CC	06-00560	6	0.625	Ball	5.38	660	2000	3.47	\$80.00
NW600CC.75	06-00561	6	0.75	Ball	5.38	660	2000	3.47	\$80.00
NW600CC.75R	06-00562	6	0.75	Taper/Roll	5.38	1185	3560	3.52	\$124.00
NW80CC-Z	06-00563	8	0.625	Ball	3	660	2000	5.02	\$89.00

LG



GERDES 4-INCH NOSE WHEEL

4 Inch Nosewheel for use with a 3/4" dia. axle. Cast aluminum construction with sealed bearings. Will accommodate an 8" dia. 2.80-4 tire on VE, LE, COZY or a 10" dia. 4.10-4 or 10x3.50x4 tire on Cozy Mark IV. All replacement parts available.

P/N A-1230ea. **\$82.75**

Replacement Bearing SetP/N A-1230-1**\$44.30**

CLEVELAND NOSE WHEELS 500X5 NOSE

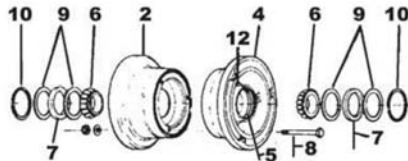

GO-CART WHEELS

Cast aluminum wheels with 4" hub, for homebuilts and sailplanes. Used on Tri-Q conversion as nose-wheel. 3-1/4" wide. Complete with 5/8" dia. ball bearings. Wt. 1-1/2 Lbs.

P/N 06-16540**\$45.50 Ea.**

CLEVELAND NOSE WHEELS 500X5 NOSE

GOODRICH 800x4 WHEELS & BRAKES

Part No.	Description	Qty. / Assy.	Price ea
D3-13A1	Wheel ass'y	1	\$421.89
A85-218	Ring, lock	2	\$103.90
08125	Cone, bearing	2	\$19.50
MS24665-132	Cotter pin	1	\$0.02
A85-118	Ring, lock	1	\$3.75
B11-5	Rim, side	1	\$32.60
B13-4	Drum, brake	1	\$134.95
08231*	Cup, bearing	2	\$9.90
D2-113	Brake ass'y	1	\$887.00
A155-1**	Bleeder ass'y	1	\$36.00
AN6204-1**	Valve	1	\$22.20
AN365-1032	Nut	6	\$0.09
B51-72	Fairing	1	\$58.50
B21-35	Spring, Retr.	6	\$5.10
D12-101	Frame, Brake	1	\$73.00

FIG.	OLD PART NUMBER	PART NUMBER	DESCRIPTION	QTY. PER ASSY.			PRICE EACH
				40-77	40-77A	40-85 40-87A	
2	162-28	162-02800	Outer Wheel				\$198.95
	162-36	162-03600	Outer Wheel				\$150.95
12	08231	214-00300	Cup Bearing				\$9.90
	217-1	217-00100	Grommet				\$2.55
4	161-31	161-03100	Inner Wheel Half Assy.				\$595.00
	161-38	161-03800	Inner Wheel Half Assy.				\$177.95
5	08231	214-00300	Inner Cup Bearing				\$9.90
	103-1050	AN4-22A	Bolt				\$0.32
*	095-10400	AN960-416	Washer				\$0.03
	094-10300	AN365-428A	Nut				\$0.09
	153-1	153-00100	Ring-Grease Seal				\$4.85
	153-8	153-00800	Ring-Grease Seal				\$5.50
9	21-104	153-00200	Ring-Grease Seal				\$5.20
	155-2	155-00200	Ring-Snap				\$6.50
7	154-1	154-00100	Felt-Grease Seal				\$4.80
	154-6	154-00600	Felt-Grease Seal				\$3.97
6	08125	214-00400	Cone-Bearing				\$19.50

500 X 5 NOSE WHEEL with 1-1/4" dia. bearings. Model No. 40-77A, used on some models of Cessna 150, is typical of nose wheels used on general aviation aircraft. FAA-approved.

P/N 40-77A**\$364.95**

600 X 6 NOSE WHEEL with 1-1/2" dia. bearings. Model No. 40-76A (not illustrated) is used on some models of Cessna 172 and 182.

FAA approved. P/N 40-76A ..**\$328.95**

WHEELS & BRAKES

CLEVELAND WHEEL & BRAKE CONVERSION KITS



REPLACE 800 x 4 WHEELS ON PIPER AIRCRAFT

A bolt-on 600 x 6 wheel and brake conversion kit for Piper models: J3, J5C, PA11, PA12, PA14, PA15, PA16, PA17, PA18 & PA20 PA18-150 & PA18A-150 with Form 337. The 199-71-STC kit comes complete with STC paperwork so form 337 is not required. Accommodates tire sizes 600 x 6, 700 x 6, 800 x 6. No landing gear modifications required. Minor modification of hydraulic line required. Uses double puck brakes. Fits 1-1/4" diameter axle size only. Fits Piper J4/J5 but STC does not cover these aircraft.

MAGNESIUM MODEL FOR GENERAL USE
 P/N 199-71\$1,019.00
 P/N 199-71C (Chrome) \$1,213.00
 P/N 199-71-STC (w/full STC paperwork)..... \$1,213.00
ALUMINUM MODEL FOR "AG" SERVICE
 P/N 199-71A \$1,190.00

Part No.	Description	Qty.
040-09804	Wheel Assy.	2
030-06602	Brake Assy.	2
*067-02900	Spacer	2
*067-03200	Spacer	2
040-07602	Nose Wheel Assy.	1
*067-03100	Spacer	2
157-01000	Dust Shield	2
102-00600	Screws	6
095-15100	Washers	6
*207-00300	Hydraulic Line	2
*50-29	Installation Drawing NLG	1
*50-30	Installation Drawing MLG	1
*	Supplemental type cert.	1

#199-52 NAVION CONVERSION KIT
 Complete kit for conversion to Cleveland 700 x 8 main gear and 600 x 6 nose wheel on Navion Models - A, B, C, D, E, F, G & H.
 P/N 199-52\$2,210.00

#199-52A NAVION CONVERSION KIT - Kit for conversion of main gear only.
 P/N 199-52A\$2,039.00

REQUEST QUOTATION ON UNLISTED MODELS

PIPER AZTEC - BRAKE

P/N 199-63 \$2,598.00



Description	Part No.	Qty.
Brake Assembly	30-96	2
Brake Disc	164-57	2
Nameplate	166-74	2
Installation Instructions	E.S.B. 7000-4	1

CESSNA - WHEEL & BRAKE
 P/N 199-46\$967.00
 P/N 199-46C(Chrome) \$1,098.00
 (6.00x6) FOR CESSNA MODELS: 120, 140, (SN 8004 thru 13399), 140A (SN 13400 and up), 170, 170A, 170B, 172, 172A thru 172E, 175, 175A, 175B, 175C, P172D, 180, 180A thru 180E, 182, 182A thru 182G.

Description	Part Number	Qty.
Wheel Assy.	040-09701	2
Brake Assy.	030-06301	2
Bushing	145-02200	8
Bushing	145-01000	4
W & B Assembly Dwg.	• 20-134	1
Installation Instructions	• 50-24	1
Installation Instructions	• 50-25	1
Installation Instructions	• 50-26	1
Supplemental Type Certificate	•	1

GLOBE SWIFT

P/N 199-48\$1,263.90
 P/N 199-48C (Chrome) \$1,489.00
 WHEEL AND BRAKE CONVERSION KIT (6.00 X 6)
 FOR GLOBE SWIFT MODELS GC-IA, GC-IB.

NOTE: It will be necessary to change master cylinders and obtain the necessary axle hardware for conversion, Ref. dwg. 50-28. These parts can be obtained through Beech aircraft.

Description	Part Number	Qty.
Brake Assembly	030-07902	2
Wheel Assembly	040-11303	2
Spacer	067-02400	2
W & B Assembly Dwg.	20-130	1
Installation Drawing	50-23	1
Supplemental Type Certificate	•	1

BEECH - WHEEL & BRAKE

P/N 199-49\$1,328.00
 P/N 199-49C (Chrome) \$1,796.00
 (6.00x6) FOR BEECH AIRCRAFT MODELS: 35, A35 thru G35, 35R, 35-33, 35-A33, 35-B33, 35-C33, 35-C33A, E33, E33A, E33C, F33, F33A, F33C, G33, H35, J35, K35, M35, N35, P35, S35, V35, V35A, V35B, 36, A36.

DESCRIPTION	PART NUMBER	QTY.
Brake Assembly	030-05400	2
Wheel Assembly	040-08300	2
Spacer	• 067-02600	2
W & B Assembly Dwg.	• 20-69	1
Installation Drawing	• 50-28	1
Supplemental Type Certificate	•	1

BEECH - WHEEL & BRAKE

P/N 199-50\$1,958.00
 (7.00x8) FOR BEECH AIRCRAFT MODELS: 35, A35 thru G35, 35R, H35, J35, K35, M35, N35, P35, S35, D55, D55A, E55, E55A 95, B95, B95A, D95A, E95, 95-55, 95-A55, 95-B55A, 95-B55B, 95-C55, 95-C55A.

DESCRIPTION	PART NUMBER	QTY.
Brake Assembly	030-06600	2
Wheel Assembly	040-09800	2
Spacer	• 067-02500	2
Spacer	• 067-02700	2
W & B Assembly Dwg.	• 20-135	1
Installation Drawing	• 50-27	1
Supplemental Type Certificate	•	1

NOTE: It will be necessary to change master cylinders and obtain the necessary axle hardware for conversion, Ref. dwg. 50-27. These parts can be obtained through Beech aircraft.

CESSNA - WHEEL & BRAKE

P/N 199-60\$1,059.00
 P/N 199-60C (Chrome) \$1,217.00
 (6.00x6) FOR CESSNA MODELS: 180, 180A, B, C, D, E, F, H, J, 185, 185A, B, A185E, A185F, 206E, 206F, TU206E, TU206F, 210, 210A, B, C, 210K, L, T210K, T210L.

Description	Part Number	Qty.
Wheel Assembly	040-07502	2
Brake Assembly	030-05200	2
Installation Drawing (210 series)	• 50-34	1
Installation Drawing (180,185,206 Series)	• 50-35	1
Supplemental Type Certificate (210 series)	•	1
Supplemental Type Certificate (180,185,206 Series)	• 20-64	1

NOTE: Kit to be used only on aircraft with 6.00 x 6 tires.

CESSNA - WHEEL & BRAKE

P/N 199-62\$1,047.00
 P/N 199-62C (Chrome) \$1,326.00
 (6.00x6) FOR CESSNA MODELS: 180, 180A, B, C, D, E, F, H & J, 185, 185A, B, A185E, A185F, 206E, F, TU206E, TU206F.

Description	Part Number	Qty.
Wheel Assembly	040-07504	2
Brake Assembly	030-05213	2
Installation Drawing	• 50-36	1
Supplemental Type Certificate	•	1

NOTE: Kit to be used only on aircraft with 6.00 x 6 tires.

CESSNA - WHEEL & BRAKE

P/N 199-84\$1,027.00
 P/N 199-84C (Chrome) \$1,167.00
CESSNA APPROVED RETROFIT FOR THE FOLLOWING AIRCRAFT:
 150, F150, A150, FA150, 152, A152, F152, FA152, 177, 177RG, F177RG, 182, A182, F182

DESCRIPTION	PART NUMBER	QTY.
Wheel Assembly	030-07500(1)	2
Brake Assembly	040-11300(2)	2
Installation Drawing	50-36	1

NOTE CESSNA CROSS REFERENCE NUMBERS (1) C-163030-113(LH) C-163030-114(RH)
 (2) C-163001-0104

CESSNA - WHEEL & BRAKE

P/N 199-84A\$1,062.00
 P/N 199-84AC (chrome) \$1,347.00
CESSNA APPROVED RETROFIT FOR THE FOLLOWING AIRCRAFT:
 172, F172, R172, FR172

DESCRIPTION	PART NUMBER	QTY.
Wheel Assembly	030-07501(1)	2
Brake Assembly	040-11300(2)	2
Installation Drawing	50-37	1

NOTE CESSNA CROSS REFERENCE NUMBERS
 (1) C-163030-011(LH) C-163030-112(RH) (2) C-163001-0104

WE CARRY ALL CLEVELAND CONVERSION KITS

Cessna P210NP/N 199-60A\$998.00
 Cessna 310, 320P/N 199-64\$2,127.00
 Cessna 421, 340, 401, 402, 414P/N 199-76\$2,627.00
 ErcoupeP/N 199-69\$1,194.00
 Beech DukeP/N 199-73\$1,998.00
 Beech MusketeerP/N 199-124\$1,287.00
 StinsonP/N 199-87\$1,056.00

Please request quote on any unlisted kits.



MASTER BRAKE CYLINDERS

CLEVELAND MASTER BRAKE CYLINDERS



MODEL 10-35 - This model has a built-in reservoir and is used in production aircraft. Cast aluminum construction. 5/8" bore, 1.2" stroke, 0.36 cu. in. displacement. Outlet 1/8" NPT. Pin center length 8". Designed to mount on rudder pedal. Formerly Gerdes Model A-049. P/N 10-35.....**\$240.95**
MODEL 10-35 O-RING KITP/N 199-513.....**\$10.40**



MODEL 10-20 - Spring-loaded piston type assembly without reservoir. Simple design assures long troublefree service. Pin center length 7-1/2". Bore 9/16". Stroke 1.25". Weight: 10 oz. Used on Pitts Special, Acro-Sport and other homebuilts. P/N 10-20**\$219.95**
Model 10-20 & 10-19 O-ring kitP/N 06-10600**\$0.81**



MODEL 10-19 - Used on Pitts and other homebuilts. Similar to Model 10-20 except with ports aligned differently. P/N 10-19.....**\$238.95**



MODEL 10-5 - Same type construction as Model 10-20. Model 10-5 has parking brake feature, Model 10-5B does not. 1/8" NPT ports, on opposite sides of cylinder, have AN823-4D fittings for use with 1/4" brake line. Pin center length 8". Wt. 9.5 oz. Bore 0.562". Stroke 1.25". Used on Piper PA25 & homebuilts. O-Ring kit is Cleveland part No. 199-502.....P/N 10-5.....**\$877.00**
P/N 10-5B.....**\$340.95**
Model 10-5B O-Ring kit (199-502)P/N 06-10700.....**\$20.20**

LORD SHIMMY DAMPERS



This high performance shimmy damper is designed to last at least 10 yrs without maintenance & contains no hydraulic fluid, so it cannot leak. Priced at about half the cost of equivalent Cessna factory dampers. 5-yr warranty. STC'd and PMA approved for Cessna 150, 152, 172, 206, 207, some 210s & some 182s. Model SE-1051-2 for Cessna150,152,172.....P/N 05-00443**\$595.00**
 Model SE-1051-3 for Cessna150A-150FP/N 05-00444**\$595.00**
 for Cessna182 (some models).....P/N 05-00445**\$628.00**
 for Cessna 206, 207, 210.....P/N 05-00446**\$639.00**

For complete installation eligibility list see: www.aircraftspruce.com

MATCO MASTER BRAKE CYLINDERS



The **MC-5** master cylinder is a vertically mounted cylinder with a built in reservoir. The MC-5 is used individually or in a dual brake application in which it acts as a remote reservoir for the MC-4 or MC-4A master cylinder under the copilot pedals which are connected in a series. The MC-5 master cylinder measures 8.00" from end to end and 7.500" from mounting hole to mounting hole. Overall width of the MC-5 at its widest point is a trim 1.78" and the mounting clevis features a .250 mounting slot. This master cylinder can be used in place of the Cleveland Part No. 10-35.

The **MC-4** series can be mounted vertically or horizontally and uses a remote reservoir. The MC-4 is used for heel brakes as well as dual applications in which it replaces the shuttle valve in the braking system when placed under the copilot pedals and connected in a series. The MC-4 master cylinder measures 8.250 inches from end to end and 7.8 from mounting hole to mounting hole. The MC-4A master cylinder is 8.125" from end to end and 7.375" from mounting hole to mounting hole. Overall width of both master cylinders is 1.371 inches and the mounting clevis has a .250 mounting slot. The MC-4 & MC-5 have a 5/8" bore and piston and 1-1/2" of stroke or travel to provide additional fluid. The MC-4A also has a 5/8" bore and piston with a stroke of 1 inch. This master cylinder can be used in place of the Cleveland part number 10-20. Use MIL-H-5606 red hydraulic fluid.

VERTICAL STYLE - Cylinder for vertical mounting, with steel housing and reservoir. MC-5P/N 06-11000**\$81.75**
 MC-5A (0.50" shorter than the MC-5)P/N 06-00375**\$91.00**

LAYDOWN STYLE - Vertical or horizontal mounting with exterior reservoir. MC-4AP/N 06-11100**\$74.50**
 MC-4P/N 06-11150**\$74.25**

*Replacement O-Rings for Master cylinders P/N 06-11200 ..**\$0.69/ ea**



The **MC-7 MASTER CYLINDER** - The black anodized MC-6 is designed to attach to a 1" diameter control stick and function similar to a motorcycle brake. Designed for ultralight aircraft, it is completely self-adjustable as the lining wears and draws additional fluid from the cylinder. The 6:1 mechanical leverage allows the average pilot to generate 1,500 psi in the system.

MC-7 P/N 06-00014**\$158.95**

SCOTT MASTER BRAKE CYLINDER

MODEL B-711 - Standard equipment on Piper and other aircraft for many years. Rugged & troublefree. Few wearing parts. Set includes (1) #1248H left-hand and (1) #1260H right hand master cylinder. On Piper Tri-Pacer only 1 cylinder is required (#1248H, left hand).

SPECIFICATIONS

Displacement80 cu. in.
 Max. working press. 350 lbs.
 Pedal Pressure 100 lbs.
 Fluid..... MIL-0-5606
 Weight as shown..21 oz. dry wt.
 Recommended Hydraulic



* Scott now furnishes AN393-11 Clevis Pin instead of Bolt.

Left HandP/N 1248H**\$1,059.00 ea**
 Right Hand.....P/N 1260H**\$968.00 ea**
 Left & Right hand.....P/N 06-10900**\$2,027.00 Pr**

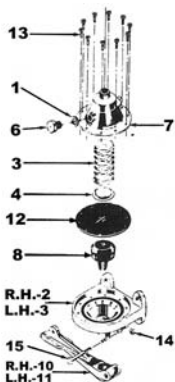

Item #	Part #	Description	No. Req.	Price Ea
1	1159	Gasket, Vent Screw	1	\$2.75
2	1220	Bracket, R.H. Unit	1	\$167.95
3	1232	Bracket, L.H. Unit	1	\$184.95
4	2003-1	Pad, Diaphragm	1	\$40.90
5	1256	Spring	1	\$12.30
6	1258	Screw, Vent	1	\$17.30
7	2728	Cover, Compression	1	\$327.95
8	1383	Piston	1	\$118.95
10	1712	Pedal, R.H.	1	\$227.95
11	1714	Pedal, L.H.	1	\$227.95
12	2844	Diaphragm	1	\$12.30
13	18377	Screw, AN500A8-8	10	\$0.23
14	18307	Washer, AN960-10	1	\$0.03
15	18431	Bolt, Aircraft*	1	\$0.42
	18481	Pin, AN380-2-2	1	\$0.02

BRAKE RESERVOIRS - RUDDER PEDALS

CLEVELAND BRAKE LINE BLEEDER

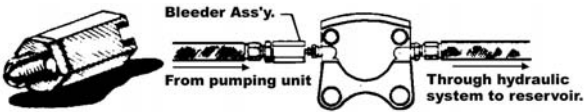

A unique tool which simplifies the brake bleeding job. This brake line bleeder can be used to service all brake assemblies utilizing the bleeder screw assembly pictured above.

P/N 87-5\$56.50



ACS BRAKE BLEEDER ASSEMBLY

Universal brake bleeder fitting. Fits all standard brake systems. 1/8" male NPT Seat is brass. Bleeder screw is stainless steel
P/N 11225\$4.65 Ea.



HYDRAULIC BRAKE BLEEDER TANK

Our Brake Bleeder Tank features a hand operated pressurizing pump for field use. It fills and bleeds in one operation. The high-impact plastic reservoir great for petroleum and water-based hydraulic fluid. NOT for use with Skydrol. You get everything needed including a universal adapter which will fit onto all brake receptacles. P/N 06-11413-1\$78.75
On Cleveland brake assemblies using a 79-3 bleeder screw the additional adapter 06-11414 is required.

HOMEBUILDERS BRAKE BLEEDER



This easy to use system allows you to quickly and easily bleed and flush your brakes without the aid of another person. By using a reverse flow system, combined with slow fluid flow, one person can fill an empty brake system in less than 15 minutes without having air in the brakes. Works on most high wing aircraft and does not require compressed air. This system is so easy that once you start the process you can walk away; come back in 15 minutes later and the job is done. Not FAA approved. P/N 06-00120\$68.75

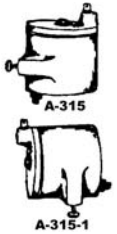

ACS MODEL A-315 RESERVOIR

Machined from 6061-T6 billet and anodized for improved corrosion resistance. Available with choice of filler port location for firewall or floor mounting. Capacity 5 oz. Size: 2-1/4" dia. x 2-1/2" long. Wt: 7oz. Specify style.

P/N A-315 (firewall mounting)\$28.60
P/N A-315-1 (floor mounting)\$28.60



ACS MODEL A-600 RESERVOIR

Machined from 6061T6 billet. cap is threaded into body and sealed with a Viton o-ring for easy filling and cleaning. cap and body have 1/8" female threads. 1-3/8" dia. x 2-3/8" high. Capacity 1.8 oz.. Can be threaded directly into master cylinder port. Two units required on most installations (one per master cylinder). Supplied with vented plug in cap and 1/8" NPT male fitting in body.
P/N A-600\$14.80 ea.



MATCO BRAKE FLUID RESERVOIR

This brake fluid reservoir from Matco features a clear plastic bowl for easy inspection of reservoir fluid. Furnished with pre-drilled aluminum flange for easy mounting. Small and compact, this reservoir mounts almost anywhere. Temperature limit is 250°F

Reservoir onlyP/N 06-11225\$21.50
Reservoir Kit (includes reservoir, tubing, & fittings for installation)P/N 06-11230\$32.50



PHILLIPS XC HYDRAULIC FLUID 5606A

ConocoPhillips Company's X/C Aviation Hydraulic Fluid 5606A is a mineral-based, aviation hydraulic fluid with low temperature properties that's capable of performing under severe operating conditions and wide temperature ranges. It's perfect for both mechanics and plane owners alike.

QuartP/N 09-00774\$5.00
CaseP/N 09-00773\$119.95

UNIVERSAL AIRCRAFT HEEL PLATES



These Universal Heel Plates can be installed in any aircraft without fasteners or hardware. Velcro secures them to the floor or carpeting. The Heel Plates are available in 22 gauge aluminum and 22 gauge stainless steel, and both are furnished with a clear finish. The aluminum plates are furnished gold anodized with a clear finish, but are also available color anodized in blue, black, silver, red, green, or yellow. The stainless plates are available in brush finish only. Any of the heel plates can be customized by 1/2" high vinyl letters for aircraft name and tail numbers. Plates are 8" wide x 12" long with Velcro strips supplied, but not mounted. Sold in sets of two plates.

Stainless steel brush finish heel plates05-00839\$60.25
SPECIAL ORDER COLORS AVAILABLE



ACS RUDDER PEDALS

Professionally made black powder coated aluminum pedals as used in production aircraft. Approved by Rutan Aircraft Factory for use on the Defiant. 5"W x 6"L. Wt. 3/4 lb. ea. P/N A-1260 \$50.50 Pr.

Discount Less 10% on 6 Pr., 15% on 12 Pr., 20% on 20 Pr.



ACS RUDDER PEDAL/TOE BRAKE ASS'Y

For use with any standard master brake cylinders. 2-piece design. Completely finished, assembled, ready for installation. Wt. 2 lbs. each.

P/N 11350 Set of 2 \$106.95

Discount Less 10% on 6 Pr., 15% on 12 Pr., 20% on 20 Pr.



AZUSA STEEL PEDAL SET

This rugged pedal set (left & right) features built-in stops, (4) 1/4" pre-drilled holes to allow adjustable rod connections and a 5/16"-18 x 1-3/4" long mounting volt. Wt 7oz. ea. length 6.5" P/N 06-00107\$11.50 /set

DELUXE HOMEBUILDERS \ RUDDER PEDAL KITS

Designed for single or two place tandem seating experimental aircraft. The pedals are aluminum castings and the hinge bracket and pedal pivot pin are constructed from 4130 steel tubing. The pedals have an attachment point (1/4" hole) at the top to link the toe brake from the rear cockpit to the front cockpit only (2 master cylinders required). To mount the pedals the builder will need 2 steel bushings 3/4" long to weld through the fuselage and a tube to put through the bushings and the bottom tube of the hinge bracket. Will work well in almost any homebuilt aircraft.

Single Place KitP/N 06-17015\$194.95
Two Place Tandem KitP/N 06-17025\$335.95

RUDDER PEDALS FOR EXPERIMENTAL AIRCRAFT

Designed for the Loehle 5151 Mustang/P-40 these rudder pedals can easily be adapted to many light sport planes and ultralights. Made from spaceage polycarbonate, a material that is used when strength, light weight and durability are a necessity. Sample rudder pedals were shot with a .22 long rifle at a range of 10 yds, bullets failed to penetrate the 1/8" inch thick polycarbonate.

Builder will have to fabricate simple back plates from either 1/8" thick birch plywood or 1/8" thick aluminum. An easy to understand detailed drawing is furnished with each set of rudder pedals. Specifications: Wt: 5.2 oz., Width: 4-1/8", Height: 9".
P/N 06-00001\$69.00



AEROSHELL BRAKE FLUID

Petroleum-base hydraulic fluid for use with brake and hydraulic systems with synthetic rubber seals. Meets specification MIL-H-5606G. Colored red.

P/N 09-27110Pint\$4.85
P/N 09-27000Qt\$4.85
P/N 09-27100Gal\$24.90

LG

CM

AXLES - BRAKE VALVES

TAPER SHIMS

For wheel alignment. Ideal setting is zero toe-in and zero camber at normal operating weight. Shims may be rotated to any one of four positions to obtain desired result.

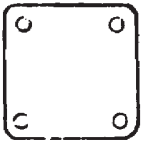

Axle Size	Shim Part No.	Approx. correction value		Price Each
		Camber	Toe-In	
500x5	0441157-1	1/2°	0.06"	\$44.00
	0441157-3	1°	0.12"	\$74.50
	0441157-2	2°	0.006"	\$102.95
600x6	0441139-5	1/2°	0.12"	\$71.75
	0441139-6	1°	0.20-0.25"	\$34.20
	0541111-2	2-1/2°	0.10-0.25"	\$126.95

DIAL-A-DEGREE SHIM

For builders using a 600x6/500x5/GAC/Azusa bolt-on axle, Dial-a-Degree is the solution to most minor alignment issues (0 to 3° adjustment). This simple solution uses a pair of specially tapered discs that are mated and rotated in any combination needed to orient each axle to its correct alignment. Each 3" dia. disc is machined and laser-cut from aircraft grade 6061 T6 aluminum. A pair of discs is used on each side. To properly align the axle, Dial-a-Degree shims are clamped in place between landing gear and axle, and the alignment checked. Loosening the clamps and rotating the tapered discs moves the axle to its proper toe-in/toe-out and correct camber angle. Drill/trim install, instructions/templates included. Will not interfere with brakes. FAA-PMA approved (BDS-101) Set of 4 discs. P/N 06-00415 ...\$120.00

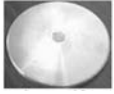

RUDDER PEDAL RETURN SPRINGS



4-1/2" Long. P/N 01-27300.. \$4.75 ea.

CLEVELAND PARKING BRAKE VALVE



Aluminum valve as used in production aircraft with Model A-110 master cylinders for dual brake installations. Complete w/AN flare fittings. P/N 60-5 \$247.95

MATCO PARKING BRAKE VALVE



This versatile parking brake valve is ideal for installation in a wide variety of homebuilt aircraft applications. The arm actuates the valve in approximately a 45 degree arc allowing for ease of installation. In-line installation can be used in conjunction with either a single or dual parking brake system setup. Its uniquely simple design allows for easy maintenance and replacement of parts. The parking brake valve body is made from 6061 anodized aluminum for lasting durability. P/N 06-17200

SCOTT PARKING BRAKE VALVE



A fine quality valve for applications in parking brake systems, helicopter rotor braking systems, pneumatic pressure controls and other hydraulic uses. Molded rubber valve seat designed for use with MIL-H-5606BB petroleum base hydraulic fluid. Maximum working pressure. Mounting holes extend through entire body. 1/8" NPT ports. P/N 4500-A1 \$144.95

GOOSENECK HOSE COUPLING



Used on high pressure strut pump hose. High pressure connection with a swivel nut and female 1/8" NPT port on other end. P/N 06-11700 \$14.85

Replacement Seal P/N SK2043-5 ea. \$0.32

STRUT VALVE



AN6287-1 strut valve for operating pressures up to 3000 PSI. Consists of a 3-piece stainless steel body, high-pressure valve core and MS20813-1B cap. P/N 4361S \$38.65

HIGH PRESSURE VALVE CORES



#2300HV (Long Type, Length 1-3/16") Operating pressure range 70-2000 PSI from -10° to 165°F. Conforms to AN809-1. P/N 2300HV\$3.75



#9914A (Short Type, Length 7/8") Same operating range as #2300HV, but doesn't conform to AN809-1. P/N 9914A\$1.39



2525 VALVE CAP (MS20813-1B)

A heat-resisting cap designed to withstand high pressure conditions. Has special rubber sealing washer. P/N 2525..... \$2.10 Ea.

AIRCRAFT SPRUCE WEST
CORONA, CA • (877) 4-SPRUCE

238

Prices Subject to Change Without Notice

AIRCRAFT SPRUCE EAST
PEACHTREE CITY, GA • (877) 477-7823

HOMEBUILDERS SPECIAL MAIN GEAR AXLES - BOLT-ON TYPE



500X5 Axle - Machined from 2024T3 aluminum. Gold anodized per specification MIL-A-8625C, Type II for improved corrosion resistance. Length 5-3/4". Mounting bolt pattern is four equally spaced 1/4" dia. holes on 1-15/16" dia. bolt circle. Thread size: 1-1/4 x 16. P/N 11701 \$39.00 Ea.

500x5 Axle - For 199-152 heavy duty discs (as used in Cozy). Same as #11701 axles above except 6" long and without undercut between bearings. P/N 11701-2 \$41.50

Spacers for 500 X 5 Axle - 2 required per axle when used with Cleveland wheels. Not required on 600x6 size. P/N 11716 \$3.65 Ea.

Extra wide spacer for 500X5 Axle - 7/16" wide as used on 199-152 heavy duty discs. 1 required per axle with P/N 11716 (Use Axle # 11701-2) P/N 11716-2 \$4.40 Ea.

600X6 Axle - Similar to 500 x 5 size but 1-1/2" dia. x 6-1/4" long. Two 5/16" dia. and two 3/8" dia. mounting holes on 2-1/4" dia. bolt circle. Thread size: 1-1/2 x 16. P/N 11702 \$58.95 Ea.

4" MATCO Axle - 9" L w/ 5/8 x18 thread P/N 06-17100.....\$42.30 Ea.

AXLES - WELD-ON TYPE

500 X 5 Axle - For use on welded type gear. Fabricated from 1-1/4" O.D. x .120 wall 4130N steel tubing. Precision ground for proper bearing fit. One end threaded 1-1/4 x 12 for round axle nut. 12" long. P/N 11703-1 \$26.60 Ea.

600 X 6 Axle - For use on welded type gear. Fabricated from 1-1/2" O.D. x .120 wall 4130N steel tubing. Precision ground for proper bearing fit. One end threaded 1-1/2 x 16 for round axle nut. 12" long. P/N 11704-1 .. \$26.80 Ea.

CITABRIA AXLES



Direct replacement steel axle for models GCA, GLBG, 7KCAB, 7ECA. 1-1/2" cad plated steel. FAA-PMA approved. P/N 05-00479\$259.95

STEEL CESSNA AXLES



For use on flat spring landing gear, Cessna models 170, 172, 180, 182, 185 and 206. It is highly recommended to replace aluminum axles with these much stronger steel axles when operating on rough conditions, with larger wheels or on skis. FAA-PMA approved. P/N 05-00481\$346.95

Cozy Landing Gear Stud - a custom fabricated 4140 steel heat treated shaft with rolled 1/2-20 threads on both ends Used a gear attachment on Cozy Mark IV. 10.75"L. 2 required. P/N 01-00254\$27.50

PIPER COMANCHE LANDING GEAR BUNGEE CORD INSTALLATION/REMOVAL TOOL



This tool allows for safe, simple, & quick bungee replacements on all Piper Comanches. Requires no dangerous levers, jacks, or vices, & does not subject the bungee cord to damage. Detailed instructions included.

Bungee Cord Installation/Removal Tool P/N 12-00912\$65.00
Open End Ratchet for use w/Bungee Tool P/N 12-00913\$24.85

AXLE NUTS

The castle-type nuts are made of 4140 alloy steel per Military Standard Drawing MS21025 as required on certificated aircraft. Many being offered are made of mild steel. The round axle nuts are made of mild steel and are acceptable on all aircraft using this type of nut.



Nut Type	Thread	Axle Type	Part No.	Price
Castle	5/8-18	Matco	06-11815	\$2.20
Castle	1-1/4-16	Cessna	06-11800	\$10.45
Castle	1-1/2-16	Cessna	06-11900	\$10.95
Round	1-1/4-12	Piper	11725	\$6.40
Round	1-1/2-16	Piper	11726	\$6.95

AIRCRAFT TIRE VALVE CORE



#6035 (38-830)(Short Type) Operating pressure range 0-400 PSI from -65° to 350°F. P/N 6035..... \$0.40

GROVE AXLES



For 500X5 Wheels w/Wheel Pant Stub - • Diameter: 1.25" • Material: Solid 2024-T3 aluminum w/anodized finish • Hole Pattern: 1-15/16" bolt circle; 1/4" dia. holes. Requires (2) P/N5710 spacers per axle. P/N 06-00601\$48.00

For 600X6 Wheels w/Wheel Pant Stub - • Diameter: 1.5" • Material: Solid 2024-T3 aluminum w/anodized finish • Hole Pattern: 2.25" bolt circle; (2) 2-15/16" dia. bolt holes & (2) 2-3/8" dia. bolt holes. P/N 06-00602\$69.00



SHOCK CORDS - RINGS



MILL FRESH SHOCK RINGS

An endless elastic ring composed of multiple strands of natural rubber, wound into a circular skein. Braided cover is high grade yarn. Manufactured to meet specification MIL-C-5651B, Type II. Shock cord is used in landing gear to reduce shock transmitted to fuselage while landing and taxiing and on other shock mounting applications. Color coded to insure fresh stock.

Ring No.	Ring Size* (In.)	Test (Lb.)	Aircraft Application	# Req.	Price/Ea.
9044	9/16x4-1/2	400	Hatz Bi-Plane	4	\$15.50
9090	9/16x9	425	Taylorcraft B	4	\$16.60
9010HD**	9/16x10	475	Taylorcraft BC	4	\$18.00
1080	5/8x8	750	Stolp Starduster, Rans 54/5	4	\$21.30
1080HD**	5/8x8	900	PA-16, PA-18 PA-20, PA-22, PA-25	4	\$15.70
1174	11/16x7-1/2	730	Piper J-2, Early J-3, J-5	4***	\$15.70
1192	11/16x9-1/4	750	Taylorcraft D	4	\$39.20
11104	11/16x10-1/2	750	Taylorcraft L-2	4	\$41.50
1280	3/4x8	750	Stolp Starduster Too	4	\$25.60
1280HD**	3/4x8	950	Piper J-3 (S/N8277 up), PA-11, PA-12, PA-14 PA-18 (thru S/N18-3013) Rans S10 Acrosport, Pitts S-2 PA-24, PA-30	4	\$18.80
8097	1-1/2 x 9-7/8	400		2	\$21.65
1286	3/4x8-3/4	750	Aeronca (S/N330 up)	4	\$34.80
1286HD**	3/4x8-3/4	950	Skybolt	6	\$35.70
1380	13/16x8	1160	Pitts (S-1, S-1C, S-1S) Husky, Acrosport 2, Rans S9	4	\$23.50

*1st dimension is cross section; 2nd dimension is inside dia. of ring.
HD - Heavy Duty, higher test rings. *6 Rings for J-5.

CW (Cold Weather) shock rings available on Special Order basis. Prices are approx. twice that of standard shock rings. Add "-CW" to standard part number when ordering.

SHOCK CORD

Made of fine natural rubber thread encased in a jacket of 2-ply woven cotton cord. Rubber strands are pre-stretched for an ultimate elongation of 120 to 140%. Treated to resist wear and oxidation. Meets specification MIL-C-5651B.

TYPE 1

Dia. (In.)	Part No.	Price/Ft. Less Than 100 Ft.	100 Ft.	Dia. (In.)	Part No.	Price/Ft. Less Than 100 Ft.	100 Ft.
1/8	06-12100	\$0.25	\$22.50	1/2	06-12500	\$1.67	\$150.30
1/4	06-12200	\$0.55	\$49.50	5/8	06-12600	\$3.40	\$306.00
5/16	06-12300	\$0.67	\$60.30				
3/8	06-12400	\$0.98	\$88.20				

SHOCK CORD FASTENERS

These cone spring hooks and locking rings are used as terminal fasteners. Insert cord through small end of cone. Apply and crimp locking ring about 1/2" from end of cord, pull cord back until locking ring contacts inside of fastener. Cut ends of cord may be sealed by dipping in rubber cement. Set includes cord and locking ring.



Shock Cord Size	Fastener P/N	Price/Set
1/4"	06-12800	\$0.71
3/8"	06-12900	\$1.05
1/2"	06-13000	\$1.56

SHOCK CORD INSTALLATION TOOL

This handy new tool installs standard shock rings on most aircraft without the great effort required in the past. This tool is designed for use with the shock cords shown above. Our price is the best anywhere.



P/N 06-16600\$195.95

BOGERT COMANCHE BUNGEE TOOL



- Lower damage risk with the right tool • Complete control of bungee shock cords coming off • Complete control of bungee shock cords going on.
 - E-Z instructions with detailed drawings • Safe landings depend on new cords every few years.
- P/N 06-00419\$86.75

BUNGEE-MASTER

THE ULTIMATE SHOCK CORD INSTALLATION TOOL

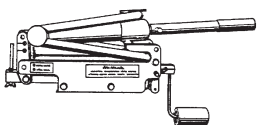

At last... a tool that takes the hassle out of shock cord installation. Bungee-Master is quick, easy, and safe. A one man operation. It is small and compact, and features all metal construction with black anodized finish. Shock cords are stretched evenly with Bungee-Master using easy bench top operation. Requires only a shop vise. Will install shock cords on J-3 Cub, PA-18 Super Cub, PA-20 Pacer, PA-22 Tri-Pacer, PA-22 Colt, and the PA-25 Pawnee P/N 06-03910\$385.95

AIRCRAFT SPRUCE WEST
CORONA, CA • (877) 4-SPRUCE

SHOCK ABSORBER COIL RINGS

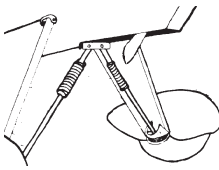

High pressure springs fabricated from alloy steel for top performance and long spring life. The Claude Gray shock absorber design has been service-proven on the EAA Biplane, Miniplane, Pitts and others. Over 1,000 pair in use. Length 6", 2" O.D., 1" I.D.. Wt. 4-1/2 lbs. per pair. Spring deflection 0.7" per 1,000 lb. force. Set of two springs.

P/N 06-13200.....\$86.25

Discount 10% on 6, 15% on 12

GRANVILLE'S STRUT SEAL



Landing gear strut packing seals shrink due to fluctuating weather conditions and age. This specially engineered hydraulic chemical additive leaves a protective coating on the strut shaft and allows the seal to expand to its normal size. It will stop strut leaks and is an excellent lubricant and corrosion preventative. Application is fast and easy - any owner or pilot can do the job in minutes. FAA approved.

Single-Strut Kit.....	P/N 06-13300	\$26.00
3-Strut Kit (Single Engine).....	P/N 06-13400	\$44.85
3-Strut Kit (Medium Twins).....	P/N 06-13500	\$55.75
Large Twin kit (16 oz).....	P/N 06-00110	\$76.50
Granville Strut Additive (Pt.).....	P/N 06-00111	\$58.95

STRUT REBUILD KITS

FOR CESSNA NOSE STRUTS

For Cessna models 150, 152, 172, 175, 182, R182, 205, 206, 210, T210, P210, 310-310Q, 320, 336, & 337. Includes 5 O-Rings, 2 Back-Up Rings, Scraper Ring.. P/N 06-03960\$13.95

FOR PIPER NOSE STRUTS

For Piper PA28-140, 150, 151, 160, 161, 180, 181, & 235, PA32-260 & 300. Includes O-Rings, Back-Up Ring, Seal, Wiper & Aluminum Gasket. P/N 06-03965\$13.95

For Piper PA28R & PA32R series retractable nose struts. Includes Seals, O-Rings & Gasket. P/N 06-03970\$16.95

FOR PIPER MAIN STRUTS

For Piper PA28-140, 150, 151, 160, 161, 180, 181 & 235, PA32-260 & 300. Includes O-Rings, Scraper, Seal & Aluminum Gasket. P/N 06-03975\$19.00

For Piper PA28R & PA32R series retractable main struts. Includes Seals, O-Rings & Gasket. P/N 06-03980\$15.90

STRUT SEAL KITS FOR PIPER



Kits contain Mil-Spec & Industry Standard Seals and Components required for various Piper Strut application Seal kit for nose or main strut for Piper Apache/Aztec

06-00126	\$13.95
Strut seal kit for Piper PA-24 main gear06-00127	\$12.95
Strut seal kit for Piper PA24 nose gear06-00128	\$12.95
Strut seal kit for Piper PA30 main gear06-00129	\$12.95
Strut seal kit for Piper PA30 nose gear06-00130	\$12.95
Main Strut seal kit for Piper PA28 140, 150, 151, 160, 161, 180, 181, 235, & PA32-260, 30006-00131	\$19.95
Nose strut seal kit for PA28-140, 150, 151, 160, 161, 180, 181, 235, & PA32-260, 300.....	06-00132	\$14.95
Main strut seal kit for PA28R & PA32R-300, 301, 301T, & PA32RT-300, 300T06-00133	\$16.95
Nose strut seal kit for PA28R & PA32R-300, 301, 301T, & PA32RT-30006-00134	\$16.95

HOMEBUILT AIRCRAFT LANDING GEAR

These custom landing gear are fabricated from aircraft grade 2024T3 aluminum. After cutting and milling, they are annealed to "O" condition for bending, and then heat-treated to "T6" condition for exceptional strength and durability. Top quality landing gear at exceptional pricing.



NOTE: Request landing gear layout sheet when placing order or quotation Request for custom landing gear to verify correct gear for application.

Aircraft Type	Part No.	Price
KITFOX - Mod 3&4 TD	06-04025	\$1,568.00
PITTS - S1	06-03915	\$956.00
S1-11B SuperStinker	06-04035	\$1,165.00
Baby Lakes	06-04070	\$824.00
VP1 - 1100B free	06-04040	\$502.00
Zenair CH701	06-00058	\$815.00

PAWNEE LANDING GEAR HYDRASORBS

These hydrasorbs for the Pawnee 235/260 landing gear are PMA'd as a heavy duty replacement for Piper part number 486-604. Hydrasorb assembly includes end fittings and 3 shock cords.

Basic Hydrasorb.....	P/N 05-01237	\$580.95
Hydrasorb Assembly.....	P/N 05-01238	\$1,050.95

TAILWHEELS

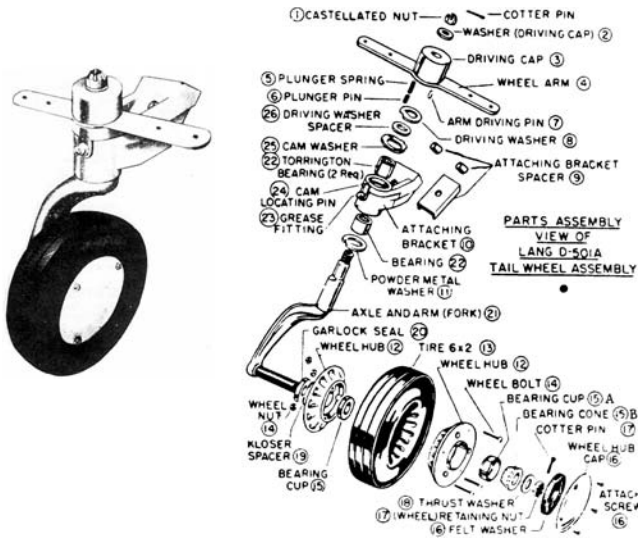

LANG TAILWHEEL PARTS

Ref No.	Lang No.	Part No.	Qty	Price Each	Ref No.	Lang No.	Part No.	Qty	Price Each
1&2	A-501,A521	06-13601	1	\$1.02	16	A-522,A-523 & A-524	06-13600	1	\$10.80
3&7	A503,A507	06-13637	1	\$9.20	17	A-521	06-13617	1	\$1.32
4	A-504	06-13604	1	\$10.30	18	A-531	06-13618	1	\$0.07
5&6	A-505,A506	06-13656	1	\$2.25	19	A-546	06-13619	1	\$1.49
8	A-509	06-13608	1	\$4.95	20	A-547	06-13620	1	\$17.40
9	A-512,A560-1 A560-2	06-13609	1	\$4.80	21	C-503	06-13621	1	\$136.20
10	C-501	06-13610	1	\$26.00	22	A-554	06-13622	2	\$6.15
11	A-516	06-13611	1	\$4.20	23	A-525	06-13623	1	\$1.40
12	A-544,A545	06-13800	2	\$104.95	24	A-508	06-13624	1	\$1.69
13	A-590	06-15800	1	\$58.85	25	A-511	06-13625	1	\$3.55
14	A-548,A549	06-13614	3	\$3.10	26	A-510	06-13626	1	\$0.85
15A	A-518	13287	2	\$8.70					
15B	A-519	13286	2	\$21.80					

HUB ASS'Y (2 #12 Hub Halves, 3 #14Bolts & Nuts)P/N 06-13800.....**\$104.95**
 HUB ASS'Y W/ BEARING CUPSP/N 06-13900.....**\$132.95**
 WHEEL ASS'Y (Hub Ass'y & 2 Bearing Cups & Cones) ..P/N 06-14000.....**\$236.95**
 WHEEL & TIRE ASS'Y (Wheel Ass'y & 6 x 2 Tire)P/N 06-14100.....**\$379.95**

THE LANG TAILWHEEL – FAA APPROVED STEERABLE – FULL SWIVEL

THE ONLY TAILWHEEL TO MEET THE EXACTING REQUIREMENTS OF THE CHRISTEN EAGLES

The Lang Model D-501-A Tailwheel is full swivel, fully automatic and steerable. It is impossible to throw the Lang tailwheel into full swivel unintentionally regardless of rough field conditions or cross winds. This tailwheel will not lock in any position except steerable, but releases easily when plane is pushed sideways or backwards by hand or when maneuvering plane on ground using brakes.

The Lang tailwheel fits both 1-1/4" and 1-1/2" leaf springs. Drop forged, heat-treated 4130 chromoly steel fork of single arm type. The cast aluminum wheel is grease packed for 100 hours service. The 6 x 2.00 solid rubber tire has interior wire reinforcement for added strength. Manufactured by ACS Products Co. under FAA-PMA. All replacement parts available. The Lang tailwheel is FAA-approved for installation on many light aircraft including Aeronca 7AC, Piper J-3 and PA-12, Cessna 140, Luscombe and Taylorcraft. Comparable to Scott Model 2000. Wt. 6 Lbs. **OEM & DISTRIBUTOR PRICING AVAILABLE** P/N D-501A**\$597.00**

HOMEBUILDERS SPECIAL TAILWHEELS

FULL SWIVEL AND STEERABLE 4 INCH DIAMETER FULL SWIVEL/STEERABLE



P/N L-691 Standard 45° spring angle, for 1-1/4" or 1-1/2" flat spring.
 P/N L-692 Optional 20° spring angle, for 1-1/4" or 1-1/2" flat spring.
 P/N L-693 10° Angle, for 5/8" round spring.
 Any Model (Wt. 3 Lbs.)**\$271.95**

***Note: Requires spacer P/N 06-13609 for use w/ 1.25" spring**

6 INCH DIAMETER FULL SWIVEL/STEERABLE



P/N L-694 Standard 45° spring angle, for 1-1/4" or 1-1/2" flat spring.
 P/N L-695 Optional 20° spring angle, for 1-1/4" or 1-1/2" flat spring.
 P/N L-696 10° Angle, for 5/8" round spring.
 Any Model (Wt. 5 Lbs.)**\$271.95**

***Note: Requires spacer P/N 06-13609 for use w/ 1.25" spring.**

HEAVY DUTY DOUBLE FORK 6 INCH DIA. FULL SWIVEL / STEERABLE



Locks in steerable mode when aircraft is moved forward. Releases to full swivel when pushed sideways or backwards, or when maneuvering on the ground using brakes. Tire is solid soft rubber, with sealed ball bearings.
 P/N 6122 - Std. - 45° Angle for 1-1/4 or 1-1/2 flat spring.
 P/N 6124 - Optional-20° Angle for 1-1/4 or 1-1/2 flat spring.
 P/N 6126 - 10° Angle for 5/8 round spring.

Any Model (wt. 6lbs.)**\$303.95**

****Note: Requires spacer P/N 06-13609 for use with 1-1/4" spring.**

REPLACEMENT WHEELS FOR HOMEBUILDER'S SPECIAL TAILWHEELS



Replacement wheels with tires & bearings for the Homebuilder's tailwheels shown above.

4" Dia. WheelP/N 06-03500**\$21.70**
 6" Dia. WheelP/N 06-03600**\$30.60**

LONGIFE SEALED BALL BEARINGS

These high quality bearings are superior to standard bearings furnished with homebuilder tailwheels P/N 06-00060**\$12.50**

RAVEN LOCKING TAILWHEELS



We have 5 versions of Raven locking tailwheel assemblies. They come with polished stainless springs plus any and all brackets and tubing to mount the tailwheel. 4" models are for aircraft like the Pitts S-1 etc. and are good up to 1250 lbs gross weight. The tailwheel assembly is 21" long and weighs 5lbs. 6" models are for aircraft like the Christen Eagle Pitts S-2 etc. and are good up to 1900 lbs gross weight. The tailwheel assembly is 24" long and weighs 7lbs.

- 4" weld in tube model, straight spring with tube to weld into fuseP/N 06-00121 **\$375.00**
- 4" bolt on model, angled spring with 3/8" hole and bracket for tail post..P/N 06-00122 **\$375.00**
- 6" weld in tube model, straight spring with tube to weld into fuseP/N 06-00123 **\$425.00**
- 6" bolt on model, angled spring with 3/8" hole and bracket for tail post..P/N 06-00124 **\$425.00**
- 4" direct replacement for RV aircraft with 7/8" ID fuse tube(23", 7lbs.)..P/N 06-00125 **\$395.00**

TAILWHEELS

ALASKAN BUSHWHEEL INC. 3200 TAILWHEEL ASSEMBLY

The Alaskan Bushwheel Tailwheel Assembly is an FAA-PMA (PMA # PQ1557NM, Supplement 9) replacement part for the Scott 3200 assembly and parts contained therein, includes Heavy Duty Steering Arm. One Year Warranty.



ABI-3224A Standard Tailwheel AssemblyP/N 06-00722\$975.00
ABI-3200B Tailwheel Assembly CompleteP/N 06-00723\$1720.00

Item	ABI P/N	Description	Our P/N	Price	Item	ABI P/N	Description	Our P/N	Price
-	ABI-3200B	ABI 3200 Tailwheel Assy.	06-00723	\$1720.00	19	AN960-816	Washer	AN960-816	\$0.12
-	ABI-3224A	Standard Tailwheel Assy.	06-00721	\$975.00	20	AN320-B	Shear Nut	AN320-8	\$1.26
1	ABI-3216-00	Bracket Assy.	06-00724	\$160.00	21	MS24665-283	Cotten Pin	MS24665-283	\$0.04
2	ABI-3241-3S	Spacer	06-00725	\$7.40	22	ABI-3222-00	Compression Spring	06-00737	\$9.10
3	ABI-3243-02	Leaf Spring Adapter 1-3/4" to 1-	06-00810	\$42.95	23	ABI-3258-00	Spacer	06-00738	\$1.88
4	ABI-3243-01	Leaf Spring Adapter 1-3/4" to 1-	06-00811	\$42.95	24	ABI-3258-01	Spacer	06-00739	\$1.88
5	ABI-3207-00	Fiber Thrust Washer	06-00726	\$5.10	25	ABI-3257-00	Pin	06-00740	\$5.70
6	ABI-3235-00	Thrust Plate Assy	06-00727	\$33.10	26	ABI-32872*	Axle	06-00741	\$31.20
7	ABI-3233-00	Compression Spring	06-00728	\$2.25	27	ABI-3225-00	Tab Lock Washer	06-00742	\$4.35
8	ABI-3256-02	Heavy Duty Dust Cap, Upper	06-00729	\$17.90	28	ABI-3227-00	Spacer	06-00743	\$15.90
8A	ABI-3255-02	Standard Dust Cap, Upper	06-00814	\$20.70	29	33475-008	Castle Nut (AN310-8)	AN310-8	\$1.46
9	ABI-3206-00	Thrust Washer	06-00730	\$11.40	30	ABI-S2*	Rim Spacer	06-00744	\$59.00
10	ABI-3214T	Heavy Duty Steering Arm Assy	06-00731	\$165.00	31	ABI-3244-00	Wheel Half	06-00745	\$85.00
10A	ABI-3214-00	Standard Steering Arm Assy	06-00812	\$165.00	32	ABI-7024	Bearing Race Seal	06-00746	\$6.30
11	ABI-3219-00	Pawl	06-00732	\$26.00	33	AN4-34A*	Wheel Bolt	AN4-34A	\$0.75
12	ABI-3256-01	Heavy Duty Dust Cap, Lower	06-00733	\$23.50	33A	AN4-7A*	Wheel Bolt	AN4-7A	\$0.21
12A	ABI-3205-01	Standard Dust Cap, Lower	06-00813	\$16.80	34	ABI-1154R*	Tire	06-00747	\$350.00
13	ABI-3205-00	Bushing	06-00734	\$12.50	34A	280x2.50x4**	Tire	06-00748	\$39.60
14	ABI-F1*	Tailwheel Fork	06-00735	\$441.95	35	3347B-202	Self Locking Nut	3347B-202	\$0.10
14A	ABI-3224**	Tailwheel Fork (Standard)	06-00736	\$192.95	36	1/4" Washer	Flat Washer	AN960-416	\$0.03
15	A4050	Cone Bearings	13286	\$21.80	37	T7201	Zerk Fitting	06-00753	\$0.72
16	A4138	Bearing Race	13287	\$8.70	38	ABI-232-046	Dowel Pin	06-00749	\$8.80
17	ABI-1863	Grease Retainer	06-00746	\$6.30	39	ABI-2602*	Gasket	06-00750	\$2.30
18	ABI-2504-1	Spacer	06-00752	\$10.80					

Note:
 * Parts not included in ABI-3224A Assembly
 ** Parts not included in ABI-3200B Assembly



REPLACEMENT PARTS FOR SCOTT 3200 TAILWHEEL

Item No.	Part No.	Description	No. Req'd	Price Ea.
1	3216	Bracket Ass'y	1	\$510.00
2	800613	Bracket Ass'y*	1	\$591.00
3	3207	Washer, Thrust	1	\$4.95
4	3234	Thrust Plate Ass'y	1	\$39.10
5	3233	Spring, Compression	5	\$2.90
6	3235-2	Dust Cap	1	\$16.40
7	3206	Washer, Thrust	2	\$9.80
8	3214	Arm Assembly	1	\$214.95
9	3219	Pawl	1	\$23.10
10	3235-1	Dust Cap	1	\$16.90
11	3224	Fork Ass'y	1	\$318.95
12	13286	Cone Bearing	1	\$21.80
13	1863	Retainer, Grease	1	\$5.60
14	2504-1	Spacer	1	\$10.40
15	18107	Washer, AN960-816	2	\$0.12
16	18450	Nut, Shear AN320-8	1	\$1.26
17	18482	Pin, Cotter	2	\$0.02
18	3222	Spring	1	\$6.90
19	3258	Spacer	1	\$1.89
20	3258-1	Spacer	1	\$2.30
21	3257	Pin	1	\$6.40
22	3236	Axle Ass'y	1	\$37.30
23	3225	Washer, Lock	1	\$12.90
24	18443	Nut, Castle, AN310-8	1	\$1.46
25	3244	Wheel Ass'y	1	\$468.95
26	2600	Tire & Wheel Ass'y	1	\$884.00
27	3205	Bushing	1	\$35.50

REPLACEMENT PARTS FOR SCOTT 3200 TAILWHEEL

Tire & Wheel Assy P/N 3245-1 10"						
Tire & Wheel Assy P/N 2600 8"						
Item No.	Part No.	Description				Price Each
1	3227	Spacer	2	2		\$15.70
2	1863	Retainer, Grease	2	2		\$5.60
3	1862	Spacer	2	2		\$17.80
4	13286	Bearing Cone (A-4050)	2	2		\$21.80
5	13287	Bearing Cup (A-4138)	2	2		\$8.70
6	18438	Bolt	4	4		\$0.21
7	33478-202	Nut, Self Locking	4	4		\$0.10
8	2598	Hub	2	2		\$162.95
9	2602	Gasket	1	1		\$1.96
10	3228	8" Tire	1			\$29.95
11	06-08100	10" Tire	1	1		\$34.85
12	3223	8" Tube	1			\$14.80
13	3247	10" Tube	1	1		\$32.20

SCOTT LEAF SPRING SPACERS AND SPRING KITS

- 3241-3SSpacer Only.....P/N 06-00406\$56.00
- 3243-2Spacer OnlyP/N06-00407\$54.25
- 3241-1SAdapter Kit - Converts 1-3/4" 3216 (1 3/4") bracket to 1-1/2" widthP/N 06-00408\$99.95
- 3239Heavy Duty Tension Spring Kit.....P/N 06-00008\$19.95
- 3216 (1-3/4") bracket to 1-1/4" widthP/N 06-00421\$101.94

MAULE WHEELS

MODEL SFSA SOLID TAILWHEELS

The SFSA tailwheel assembly is of the same type construction as the SFS-P8A unit except for the tire, which is a 6.50 x 2.50 soft rubber solid tire. Spring connector kit not furnished with this model. FAA-approved. Wt. 6 lbs.

- SFSA-1-4, for 1-1/4" SpringP/N 06-16710**\$229.50**
- SFSA-1-2, for 1-1/2" SpringP/N 06-16720**\$229.50**
- Replacement Tire & BearingsP/N TW-23A**\$128.50**

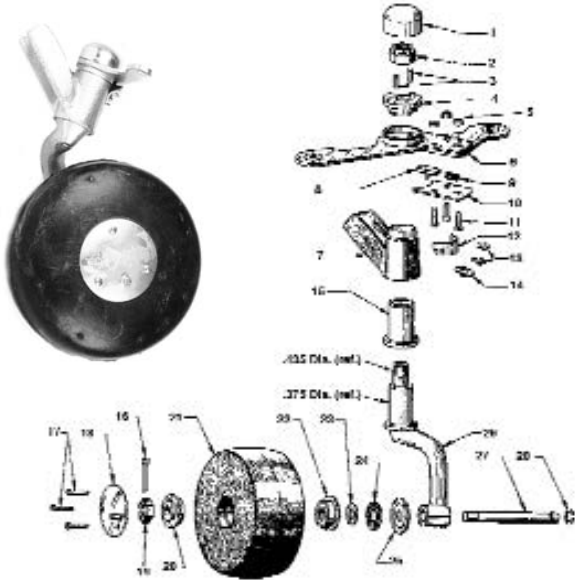

MODEL SFS-P8A PNEUMATIC TAILWHEELS

An inexpensive 8" pneumatic tailwheel assembly which is steerable and full swiveling, with new improved single arm shimmy-free fork. All working parts heat treated. This model is furnished with a compression anti-shimmy spring connector kit. FAA approved. Wt. 7 lbs.

- SFS-P8A-1-4, for 1-1/4" SpringP/N 06-16730**\$249.50**
- SFS-P8A-1-2, for 1-1/2" SpringP/N 06-16740**\$249.50**
- Tire (2.80 x 2.50 x 4)P/N 06-08000**\$29.95**
- Tube (2.80 x 2.50 x 4)P/N 06-08101**\$14.80**

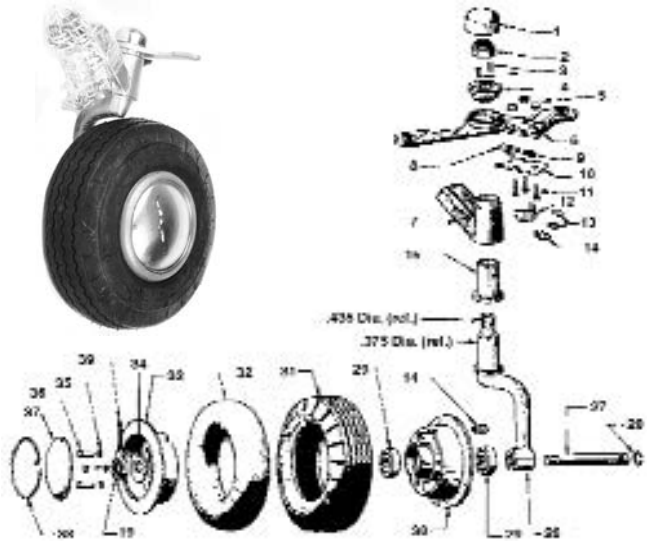

LG

MAULE P8B TUNDRA TAILWHEEL



A new tailwheel with 8" pneumatic tire designed and engineered to meet the toughest conditions on all types of airports and landing fields.

- SFS-P8B-1-4** For 1-1/4" Leaf Spring WidthP/N 06-16750**\$348.95**
- SFS-P8B-1-2** For 1-1/2" Leaf Spring WidthP/N 06-16760**\$348.95**
- SFS-P8B-3-4** For 1-3/4" Leaf Spring WidthP/N 06-16770**\$348.95**

MAULE TAILWHEEL PARTS LIST

Old Style (Pre 1976) has 3/4" Fork Shaft & New Style (Post 1976) has 7/8" Fork Shaft		Old Style SFS-P8 Pneumatic or SFS Solid Rubber	New Style SFS-P8A Pneumatic and SFSA Solid Rubber	Qty.	Price	Old Style (Pre 1976) has 3/4" Fork Shaft & New Style (Post 1976) has 7/8" Fork Shaft		Old Style SFS-P8 Pneumatic or SFS Solid Rubber	New Style SFS-P8A Pneumatic and SFSA Solid Rubber	Qty.	Price
Fig#	Description	Part Number	Part Number	Req.	Each	Fig#	Description	Part Number	Part Number	Req.	Each
1	Cover Cap	TW-18 (1-1/4")	TW-63A (1-3/8")	1	\$5.40	25	Retainer Washer	TW-64	TW-64	1	\$0.05
2	Nut	AN364-720 or AN365-720	AN364-720 or AN365-720	1	\$1.14		Fork (with axle) Pneumatic	06-00092	TW-58A	1	\$69.50
3	Lock Ring Pin	TW-17	TW-60AB	1/2	\$0.27		Solid Rubber	06-00093	TW-61A-1	1	\$69.50
4	Lock Ring	TW-16	TW-57A	1	\$15.30	27	Axle	TW-5	TW-5	1	\$21.50
5	Nut	AN364-440	AN364-440	3	\$0.13	28	Axle Sircclip Ring	TW-6	TW-6	1	\$0.40
6	Steering Arm Assembly*	TW-15	TW-15A	1	\$46.20	29	Bearing	TW-A7	TW-A7	2	\$41.95
7	Bracket Assy., 1-1/4 In	06-16101	06-16201	1	\$69.50	30	Inboard Wheelhalf, with bearings	TW-30	TW-30	1	\$92.90
	Bracket Assy., 1-1/2 In	06-16102	06-16202	1	\$69.50	31	Tire, 8-inch			1	
	Bracket Assy., 1-3/4 In	TW-22-3-4		1	\$51.00	32	Tube			1	
8	Lock Pin	TW-13	TW-13	1	\$14.80	33	Outboard Wheelhalf	TW-31	TW-31	1	\$25.20
9	Steering Arm Spring	TW-14	TW-14	1	\$0.18	34	Washer	TW-A6	TW-A6	1	\$0.20
10	Lock Cover Plate	TW-12	TW-12	1	\$3.95	35	Lock Washer	AN935-516	AN935-516	3	\$0.02
11	Screw	MS35206-217	MS35206-217	3	\$0.05	36	Bolt	TW-A12	TW-A12	3	\$3.05
12	Cam	TW-10	TW-10	1	\$7.20	37	Hub Cap	TW-32	TW-32	1	\$11.60
13	Screw	AN501-10-4	AN501-10-4	2	\$0.30	38	Hub Cap Sircclip Ring	TW-33	TW-33	1	\$1.13
14	AN520-10-4AN520-10-4 Zerk Fitting	TW-7-A14		1	\$2.15	39	Cotter Pin	AN380-3-3	AN380-3-3	1	\$0.04
15	Oilite Bearing	TW-7 (3/4" I.D.)	TW-59A (7/8" I.D.)	1	\$4.90	<i>Item 40 thru 44 are used on the "Old" style & pneumatic tailwheels that have a shimmy dampener.</i>					
<i>Item 16 through 25 are for the solid rubber tire assembly only.</i>						40	Adjusting Screw	TW-40		1	\$6.45
16	Cotter Pin	AN380-3-3	AN380-3-3	1	\$0.04	41	Dampener Spring	TW-41		1	\$0.47
17	Screw	TW-A18	TW-A18	3	\$0.22	42	Friction Block	TW-42		1	\$13.50
18	Hub Cap	TW-27	TW-27	1	\$10.85	43	Hex Housing	TW-43		1	\$13.50
19	Axle Nut	AN320-8	AN320-8	1	\$1.26	44	Bracket Assembly, 1-1/4 inch drilled	TW-44-1-4		1	-----
20	Bearing	TW-A15	TW-A15	1	\$5.35		Bracket Assembly, 1-1/2 inch drilled	TW-44-1-2		1	-----
21	Tire-solid, no bearings	TW-23	TW-23	1	\$63.75						
	Tire-solid, with bearings	TW-23A	TW-23A	1	\$128.50						
22	Bearing (with washer)	TW-A15	TW-A15	1	\$5.35						
23	Washer	TW-28	TW-28	1	\$1.55						
24	Felt Seal	TW-26	TW-26	1	\$0.27						

WE BEAT ANY COMPETITOR'S ADVERTISED PRICES!

AIRCRAFT SPRUCE WEST
CORONA, CA • (877) 4-SPRUCE

242
Prices Subject to Change Without Notice

AIRCRAFT SPRUCE EAST
PEACHTREE CITY, GA • (877) 477-7823

TAILWHEELS

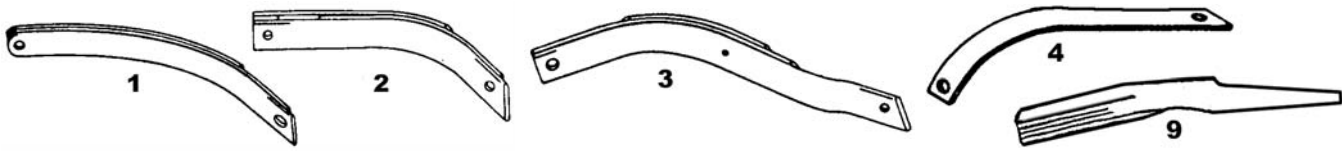

STEEL TAILWHEEL LEAF SPRINGS

Set No.	Spring Width	Hole Dia. Fuselage End	Hole Dia. Tailwheel End	Distance Between Bolt Centers	Original Application	Wt. Lbs.	No. of Springs	Part No.	Price
1	1-1/4"	7/16"	3/8"	12"	Piper J3, PA11, PA11, PA12, PA14, PA15, PA17	3-1/8	3	06-14200	\$98.25
2	1-1/2"	3/8"	3/8"	10"	T-Craft BC-12D	2-3/4	3	06-14300	\$106.95
3	1-1/2"	3/8"	7/16"	15"	Aeronca 7AC, 11AC	3-1/2	3	06-14400	\$90.00
4	1-1/2"	3/8"	3/8"	15"	Homebuilts	1-3/4	1	06-14500	\$34.80
5	1-1/4"	5/16"	3/8"	11-3/4"	Luscombe	3-1/2	4	06-14600	\$103.95
6	1-1/4"	Main Leaf Only		11-3/4"	Luscombe	1-1/2	1	06-14700	\$37.00
7*	1-1/2"	5/8"	7/16"	13-1/8"	Cessna 120-140	4	4	06-14800*	\$146.95
8	1-1/2"	Main Leaf Only		13-1/8"	Cessna 120-140	1-1/2	1	06-14900	\$51.85
9	1-1/2"	5/8"	7/16"	13"	Cessna 170	5	5	06-15000	\$167.95
10	1-1/2"	Main Leaf Only		13"	Cessna 170	1-3/4	1	06-15100	\$71.00

DISCOUNTS LESS 10% ON 6, 15% ON 10 (ASSORTED) *P/N 06-14800 has two bends

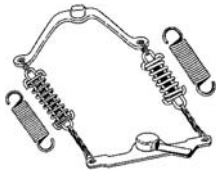

MAULE ANTI-SHIMMY CONNECTOR SPRING KITS

A high and low frequency spring is used to upset the natural frequency of the tailwheel. The lighter spring is used on the left side.

Compression Type Kit....P/N 06-15150\$24.90



TENSION TYPE CONNECTOR SPRING KITS

Kit consists of two tension type springs, two chains and two connector links.

Lightweight Spring Kit Scott ..P/N 2151Ea \$45.00
 Connector LinksP/N 06-15400Ea \$1.82
 Chain.....P/N 06-15500Ft \$0.90



COMPRESSION TYPE CONNECTOR SPRING KIT

Replace conventional springs with new compression type. Original tension type springs keep rudder post under continuous tension which wears the hinges. Compression type springs keep rudder neutral - no tension on post. Assures more effective steering action.

Set of 2 stainless steel springs, (2) 1' chains, 4 connector clips:
 P/N 06-15600.....\$19.78
 Springs OnlyP/N 06-15700Ea \$5.20
 Connector ClipsP/N 06-15400Ea \$1.82
 ChainP/N 06-15500 \$0.90/Ft



RUDDER ARMS

Cast aluminum brackets with reinforced chain mounting holes. Originally used on Piper J-3, J-4, J-5, PA-11, PA-18, L-21B. 3/4" dia. post between mounting holes.

ScottP/N 1140\$98.25



HOMEBUILDERS MODEL - Same style as Scott model. 1" dia. post and 3/4" arm (width)
 P/N 06-15900.....\$36.20



SOLID



PNEUMATIC

MATCO TAILWHEELS

Matco tailwheels use a fiberglass reinforced nylon wheel with an operating load of 450 lbs. It takes over 5000 lbs to fail the wheel and it will hold up in the most rigorous conditions. Can be used with 1-.25" or 1.5" leaf spring. These tailwheels are fully steerable, full swivel, and are available with a 6" hard rubber solid tire or with 8" Shin pneumatic tire and tube for heavier aircraft. Tailwheel construction is anodized aluminum. Wt: 5 lbs.

Matco solid rubber tire tailwheel assembly
 P/N 06-01615\$141.95
 Replacement TireP/N 06-00004\$73.00
 Matco pneumatic tire tailwheel assy:..P/N 06-01620\$202.95
 Replacement TireP/N 06-08000\$29.95
 Replacement TubeP/N 06-08101\$14.80
 Replacement Wheel.....P/N 06-00565\$78.00



ORIGINAL HEATH TAILWHEEL

Steerable tailwheels as used on Piper J3 and many other early model aircraft. Furnished with 5/8" dia. axle and complete with wheel and tire. Fork width 2-1/2". For 1-1/2" wide tailwheel leaf spring. Wt. 5.2 lbs. Solid rubber tire, full swivel.

Heath TailwheelP/N 06-16000\$156.95
 Replacement Tire & BearingsP/N 06-03600\$30.60



TAILWHEEL TIRES

6X2 General solid tire - A flexible rubber tire with four knobs on center hole. This is Scott P/N 1879 used on Scott Model 2000 tailwheels and some Scott 3-24B tailwheels. Also used on Lang D-501A tailwheel. Replaces Goodyear 6x2 (11 knobs) solid tailwheel tire. P/N 06-15800.....\$58.85

6.50 x 2.50 SOLID TIRE - Maule P/N 23 for Model SFSA tailwheels.
 Tire OnlyP/N TW-23\$63.75
 Tire w/ Bearings.....P/N TW-23A\$128.50

2.80/2.50 x4 McCREARY PNEUMATIC TIRE - Used on Scott Model 2600 8" wheel assembly.
 TireP/N 06-08000\$29.95
 TubeP/N 06-08101 \$14.80

10 x 3.50 x 4 McCREARY PNEUMATIC TIRE - Used on Scott Model 3450 tailwheel and Scott Model 3245-1 10" wheel assembly.
 TireP/N 06-08100 \$34.85
 TubeP/N 06-08102\$14.70

LG

SHOCK DISKS - LANDING GEAR



AERO CLASSIC LEAKGUARD INNER TUBES

Leakguard® Inner Tubes proprietary rubber compound substantially reduces the air seepage effect that is common in standard aircraft tubes currently available. Get tomorrow's technology today!

Description	P/N	Price
Tube 500 x 5 LEAKGUARD	06-00755	\$40.00
Tube 600-6 LEAKGUARD	06-00754	\$40.00
Tube 280/250-4 LEAKGUARD	06-00760	\$40.00
Tube 410/350-4 LEAKGUARD	06-00761	\$40.00
Tube 12.5-4.5 LEAKGUARD	06-00762	\$40.00
Tube 14.50SC LEAKGUARD	06-00763	\$40.00
Tube 700/800-6 LEAKGUARD	06-00764	\$40.00
Tube 850-6 LEAKGUARD	06-00765	\$40.00
Tube 650-700-8 LEAKGUARD	06-00766	\$40.00
Tube 650-10 LEAKGUARD	06-00767	\$40.00
Tube 750-10 LEAKGUARD	06-00768	\$40.00
Tube 850-10 LEAKGUARD	06-00769	\$40.00
Tube 15/600-6 LEAKGUARD	06-00770	\$40.00

COMPOSITE LANDING GEARS



The actual landing gear systems consist of 4-6 independent parts connected into an integral component in the continuous manufacturing process. The product is treated thermally at the end of the production process in a curing chamber. The temperature is controlled by a computer with a precision of 0.10°C. The products are cured according to a special heating curve with temperatures reaching 100°C within several cycles. This significantly improves the mechanical properties of used materials

and ensures the compliance of individual products. The entire equipment is certified by an authorized national testing institute. The result is a seamless landing gear leg with several cavities that complies with the requirements of the regulation; if the takeoff weights are taken into account, the landing gear exceeds the requirements twice over. The weights of the actual landing gears are between 2 and 3 kg and can be installed into the fuselage of MTOV 450-600 kg planes. The advantage of the composite landing gears include lower weight, higher elasticity and no maintenance.

Model No.	Gross Weight (kg)	Weight (kg)	Popular Designs	Part No.	Price
NK-01	475	250	Condor, Star, ESO	05-02451	\$518.00
NK01K	550	230-250	Star, Sting-LSA, Samba XXL	05-02452	\$518.00
NK-01D	475	250	Quail, Falcon	05-02454	\$518.00
NK-03	475	250	Eurostar, Dynamic, Alt, Skylark	05-02455	\$518.00
NK-03A	475	215	Cora, Allegro 2000/SW, Arius F	05-02456	\$518.00
NK-03A-550	550	245	Zenair 601 XL	05-02457	\$518.00
NK-055	550	310	Sportstar-LSA, MD-3 Rider	05-02458	\$518.00
NK-07	500	255	Zenair 701, Guerin G1, Yuma, Smaraged	05-02459	\$518.00
NK-08	600	300-320	Parrot-LSA	05-02460	\$518.00
NK-09	550	270	Dynamic-LSA	05-02461	\$518.00



DIAPHRAGM FOR BRAKE CYLINDER FOR PIPER

P/N 06-00759.....\$9.10

BEECH TYPE SHOCK DISCS (3 GEAR LEGS)

FAA-PMA approved landing gear mounting pad cushion assembly (shock disc). Used on all three gear legs of the Beech Model 19/23/23-24 (all variants; Musketeer, Sport, Custom, Sundowner, Super), and on the nose gear of the Model 24R (all variants; Super R and Sierra). Replaces Raytheon/Beech p/n 169-380003-7. One set is required for each landing gear leg. Both main gear leg sets (at a minimum) must be replaced at the same time, to retain proper handling. The nose gear cushions should also be replaced at the same time. A Certificate of Conformance will be sent with each order for your aircraft logs.

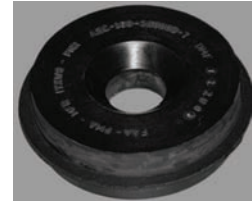

(Set of 8) P/N 06-00776.....\$495.00

BEECH TYPE SHOCK DISCS (2 MAIN GEAR LEGS)

FAA-PMA approved landing gear mounting pad cushion assembly (shock disc). Used only on the two main gear legs of the Beech Model 24R (all variants; Super R and Sierra). Replaces Raytheon/Beech p/n 169-390098-1. One set is required for each landing gear leg. Both main gear leg sets (at a minimum) must be replaced at the same time, to retain proper handling. The nose gear cushions should also be replaced at the same time (see AEC-169-380003-7). A Certificate of Conformance will be sent with each order for your aircraft logs. Wt: 5 lbs.

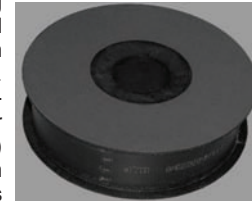

(Set of 8) P/N 06-00777.....\$495.00

BEECH TYPE STANDARD JO-BOLT

The Jo-Bolt is a standard hardware item that must be replaced each time the main landing gear is removed for replacing the mounting pad assembly (shock discs), used only on the fixed-gear Beech Model 19/23/23-24 (all variants). The retract Models 24 (Super R and Sierra) do not require these bolts. Replaces Raytheon/Beech Illustrated Parts Catalog (IPC) published P/N NAS1669-6L7. Each main fixed-gear leg will require two new bolts. Wt: 0.09 lbs



P/N 06-00778.....\$495.00

ORDER ONLINE!

www.aircraftspruce.com

- 45,000 Parts!
- 24 Hour Access!
- Fast, Easy Navigation!

LOW PRICE GUARANTEE

WE WILL MATCH ANY COMPETITOR'S CURRENT PRICE. IF YOU FIND A LOWER PRICE, PLEASE TELL US.